



Fire Your Imagination

Studio

With Infrared Remote Control



Instructions for Use, Installation and Servicing

For use in GB, IE (Great Britain and Republic of Ireland)

IMPORTANT

THIS PRODUCT HAS A NAKED FLAME. IT IS IMPORTANT TO ENSURE THAT ADEQUATE PRECAUTIONS ARE TAKEN TO ENSURE THAT NO OBJECTS COULD COME INTO CONTACT WITH THE NAKED FLAME. UNDER NO CIRCUMSTANCE SHOULD RUBBISH BE THROWN INTO OR BURNT ON THIS APPLIANCE.

PARTS OF THIS APPLIANCE WILL BECOME HOT DURING OPERATION; IT IS THEREFORE RECOMMENDED THAT A SUITABLE GUARD SHOULD BE USED FOR PROTECTION OF YOUNG CHILDREN, THE ELDERLY OR INFIRM.

These Instructions must be left with the appliance for future reference and for consultation when servicing the appliance. Please make the customer aware of the correct operation of the appliance before leaving these instructions with them.

The commissioning sheet found on Page 3 of this Instruction manual must be completed by the Installer prior to leaving the premises.

This product is not suitable for primary heating purposes.

Contents

Covering the following models

Gas Type	Studio 1	Studio 2	Studio 3
NG	8700CHEC	8701CHEC	8702CHEC
LPG	P8700CHEC	P8701CHEC	P8702CHEC

Appliance Commissioning Checklist3

User Instructions4

Installation Instructions7

Technical Specifications 7

Site Requirements..... 10

Installation 12

Commissioning 18

Servicing Instructions.....19

Servicing Requirements 19

Fault Finding.....20

How to replace parts22

Spare parts list26

Service Record30



If you have purchased your stove or fire from an authorised stockist within our Expert Retailer Network, then automatically your product will carry a 2 year warranty as standard. The 2 year warranty can be further extended to a total warranty period of 5 years by registering your Gazco Stove or Fireplace within one month of the latter of the purchase date or installation date. Accordingly, the start date for the warranty period is the date of purchase. During the registration process, the Expert Retailer details will be required for your Extended Warranty to be activated. Any product purchased outside of our Expert Retailer Network will carry a standard 12 month, non-extendable warranty.

It is a condition of the Extended Warranty that the installation complies with the relevant Building Regulations and is carried out by a suitably trained and qualified individual (GasSafe in the UK or equivalent in other countries) with the certificate of installation and the Commissioning Report on Page 3 completed and retained by the end user.

Full terms and conditions are detailed in the Warranty Statement on the Gazco website www.gazco.com. In the event of any conflict of information the wording on the website shall prevail.

Important Note: Should any problems be experienced with your product, claims must first be submitted to the Expert Retailer where the appliance was purchased from who will offer immediate assistance or contact Gazco on your behalf.



It is a requirement of the Building Regulations 2010 that the installation of this appliance is notified to the Local Authority. It is the responsibility of the GasSafe registered installer to carry out this notification to the Local Authority via the GasSafe register Competent Persons Scheme in England and Wales (different rules apply in Scotland and Northern Ireland).

When the installation has been notified, GasSafe will send a Building Regulations Compliance Certificate to you containing details of the work completed. Please ensure that the person responsible for the installation of this appliance completes this notification and records it in the Appliance Commissioning Checklist on page 3.

IT IS YOUR RESPONSIBILITY TO COMPLY WITH THE BUILDING REGULATIONS AND BE ABLE TO PRODUCE THIS CERTIFICATE SHOULD IT BE REQUIRED IN THE FUTURE.

Appliance Commissioning Checklist

To assist us in any guarantee claim please complete the following information:-

IMPORTANT NOTICE

Explain the operation of the appliance to the end user, hand the completed instructions to them for safe keeping, as the information will be required when making any guaranteed claims.

FLUE CHECK	PASS	FAIL
1. Flue Is correct for appliance		
2. Flue flow Test		
3. Spillage Test		
GAS CHECK	PASS	FAIL
1. Gas soundness & let by test		
2. Standing gas pressure	mb	
3. Appliance working pressure (on High Setting) NB All other gas appliances must be operating on full	mb	
4. Gas rate	m ³ /h	
5. Does Ventilation meet appliance requirements		
BUILDING CONTROL NOTIFICATION	YES	NO
1. Installer notified GasSafe/Local Authority of installation via Competent Persons Scheme?		

RETAILER AND INSTALLER INFORMATION

Retailer	Installation Company
Contact No.	Engineer
Date of Purchase	Contact No.
Model No.	GasSafe Reg No.
Serial No.	Date of Installation
Gas Type	

User Instructions

Welcome

Congratulations on purchasing your Studio fire, if installed correctly Gazco hope it will give you many years of warmth and pleasure for which it was designed.

The purpose of this manual is to familiarise you with your appliance, and give guidelines for its installation, operation and maintenance. If, after reading, you need further information, please do not hesitate to contact your Gazco retailer.

WARNING



In the event of a gas escape or if you can smell gas, please take the following steps:

- **Immediately turn off the gas supply at the meter/emergency control valve**
- **Extinguish all sources of ignition**
- **Do not smoke**
- **Do not operate any electrical light or power switches (On or Off)**
- **Ventilate the building(s) by opening doors and windows**
- **Ensure access to the premises can be made**

Please report the incident immediately to the National Gas Emergency Service Call Centre on 0800 111 999 (England, Scotland and Wales) , 0800 002 001 (N. Ireland) or in the case of LPG, the gas supplier whose details can be found on the bulk storage vessel or cylinder.

The gas supply must not be used until remedial action has been taken to correct the defect and the installation has been recommissioned by a competent person.

1. General

- 1.1 Installation and servicing must only be carried out by a competent person whose name appears on the GasSafe register. To ensure the engineer is registered with GasSafe they should possess an ID Card carrying the following logo:
- 1.2 In all correspondence, please quote the appliance type and serial number, which can be found on the data badge located on a plate inside the controls compartment.
- 1.3 Do not place curtains above the appliance: You must have 300mm (1') clearance between the appliance and any curtains at either side.

- 1.4 No furnishings or other objects should be placed within 1 metre of the front of the appliance.
- 1.5 If a shelf is fitted, a distance of 150mm above the appliance is required.
- 1.6 If any cracks appear in the glass panel do not use the appliance until the panel has been replaced.
- 1.7 Do not attempt to burn rubbish in this appliance.
- 1.8 This product is guaranteed for 5 years from the date of installation, as set out in the terms and conditions of sale between Gazco and your local Gazco retailer. Please consult with your local Gazco retailer if you have any questions. In all correspondence always quote the Model Number and Serial Number.

2. Lighting the Appliance

There are two ways of lighting the appliance:

1. By remote control.
2. Using the appliance touch pad.

Remote Control

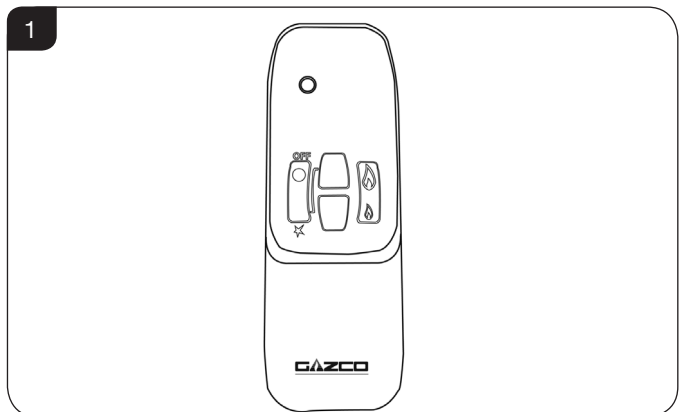

- 2.1 **To light the appliance** press the LOWER section of the LEFT hand button and the UP button simultaneously. An audible beep will be heard (the lighting sequence can take up to 30 seconds).
The pilot will light along with the main burner on high setting.
- 2.2 **Adjusting the Flame Height**
The flame height of the main burner can be:
 - **Increased** by holding down the LOWER section of the LEFT hand button and the UP button simultaneously.
 - **Decreased** by one height stage by pressing the DOWN button once.
 - Hold the DOWN button to decrease to minimum. At the lowest point the appliance goes into standby mode where only the pilot is lit.
- 2.3 **Turning the appliance Off**
Press the OFF button to extinguish the appliance.

User Instructions

Touch Pad Control

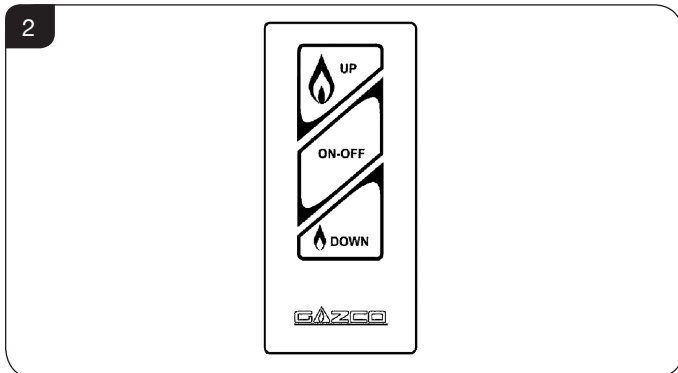

- 2.4 **To light the appliance** press the ON-OFF button (up to 30 seconds).
- 2.5 **Adjusting the Flame Height**
- Press the UP button to increase the flame height.
 - Press the DOWN button to decrease the flame height. At the lowest point it goes to 'standby mode', (only pilot lit).
- 2.6 **Turning the appliance Off**
- Press the ON-OFF button to turn the appliance off.

Emergency Shut Off Switch

- 2.7 The emergency shut off switch is located under the far right hand holes of the decorative panel - to the right of the pilot assembly.
- If the batteries fail during use of the appliance use a small blunt instrument such as a ball point pen to move the switch to the OFF (0) position, see Diagram 3.
- The switch is set to be ON (I) during normal operation and must remain on.

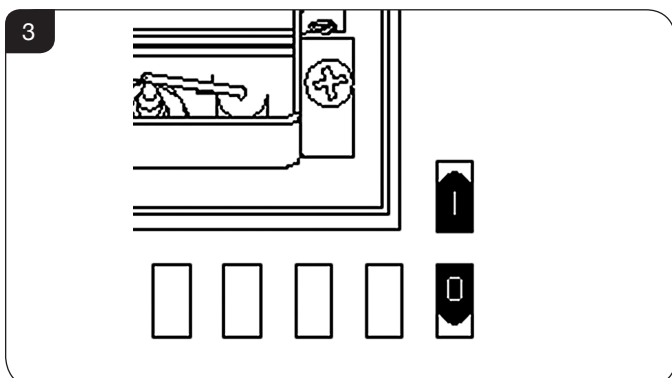

3. Cleaning the Appliance

- 3.1 Make sure the appliance and surrounds are cool before cleaning.
- 3.2 Use:
- A dry cloth or stainless steel product to clean the polished plate.
 - A damp cloth for the painted frame.
 - A damp cloth to clean the granite/enamelled inner panels.
 - A brush to remove debris from burner.

4. Changing Appliance Batteries

The appliance batteries are located behind the wall switch plate.

- 4.1 Undo the two screws securing the wall switch and plate and remove, see Diagram 4.



- 4.2 Unclip the battery holder from the wall switch plate and remove the old batteries.
- 4.3 Correctly position the four new AA size batteries and Re-assemble the battery holder as shown in Diagram 5.

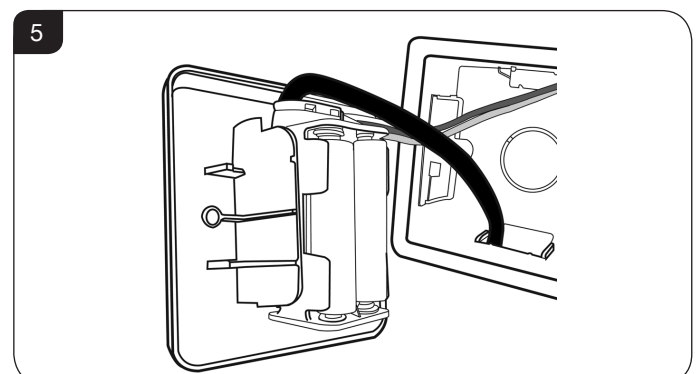

PLEASE ENSURE NO WIRES ARE TRAPPED BEFORE REPLACING THE WALL PLATE. THE LEAD IS EASILY DAMAGED.

User Instructions

5. Arrangement of Fuel Bed components

- 5.1 If you need to replace the White Stone, Glass Granules or refill the tray, make sure the fuel effects are flattened so they are level with the rim of the tray. **DO NOT OVERFILL THE BURNER TRAY.**

TAKE CARE NOT TO SPILL THE EFFECT INTO THE PILOT AREA.

ONLY GENUINE GAZCO PARTS CAN BE USED IN THIS APPLIANCE.

6. Oxygen Depletion Sensor

- 6.1 If oxygen in the room falls below its normal level, the oxygen sensitive pilot cuts off the gas supply. If this device turns the fire off, it is a warning there is a problem with the flue system. **Do not attempt to use the fire until an engineer says it is safe.**

This device is not a substitute for an independently mounted carbon monoxide detector.

7. Flame Failure Device

- 7.1 This is a safety feature incorporated on this appliance which automatically switches off the gas supply if the pilot goes out and fails to heat the thermocouple.

IF THIS OCCURS DO NOT ATTEMPT TO RELIGHT THE APPLIANCE FOR 3 MINUTES.

8. Running In

- 8.1 During initial use of a new Gazco appliance a strong odour will be encountered as various surface coatings become hot for the first time. Although these odours are harmless it is recommended that the appliance is operated on maximum for 4 to 8 hours in order to fully burn off these coatings. After this period the odours should then disappear.

If the odours persists, please contact your installer for advice.

- 8.2 During the first few hours of burning there may be discolouration of the flames. This will also disappear after a short period of use.

9. Servicing

- 9.1 The appliance must be serviced every 12 months by a qualified GasSafe Engineer. In all correspondence always quote the Model number and the Serial number which may be found on the Commissioning Checklist (Page 3).

10. Ventilation

- 10.1 Any purpose provided ventilation should be checked periodically to ensure that it is free from obstruction.

11. Installation Details

- 11.1 Your installer should have completed the commissioning sheet at the front of this book. This records the essential installation details of the appliance. In all correspondence always quote the Model number and Serial number.

12. Hot Surfaces

- 12.1 Parts of this appliance become hot during normal use.
12.2 Regard all parts of the appliance as a working surface.
12.3 Provide a suitable fire guard to protect young children and the infirm.

13. Appliance will not light

If you cannot light the Studio:

- 13.1 Check and change the batteries in the remote handset.
13.2 Check and change the wall switch batteries (see Section 4).
13.3 Consult your Gazco retailer or installer if the appliance still does not light.

Installation Instructions

Technical Specification

Covering the following models:

Gas Type	Studio 1	Studio 2	Studio 3
NG	8700CHEC	8701CHEC	8702CHEC
LPG	P8700CHEC	P8701CHEC	P8702CHEC

Model	Gas CAT.	Gas Type	Working Pressure	Aeration	Injector	Gas Rate m ³ /h	NOX Class	Input kW (Gross)		Country
								High	Low	
Studio 1	I ₂ H	Gas Natural G20	20 mbar	Ø3.5mm	390	0.657	4	6.9	4.0	GB, IE
Studio 1	I ₃₊	Butane G30	29 mbar	Both sides 15mm X 25mm	185	0.197	5	6.9	4.0	GB, IE
		Propane G31	37 mbar			0.260				
Studio 2	I ₂ H	Gas Natural G20	20 mbar	Ø3.5mm	560	0.839	5	8.8	4.5	GB, IE
Studio 2	I ₃₊	Butane G30	29 mbar	Both sides 15 mm x 25 mm	158	0.350	5	9.3	4.9	GB, IE
		Propane G31	37 mbar			0.266				
Studio 3	I ₂ H	Gas Natural G20	20 mbar	Ø3.5mm	110	1.258	5	13.2	6.3	GB, IE
Studio 3	I ₃₊	Butane G30	29 mbar	Both sides 15 mm x 25 mm	184	0.516	5	13.7	6.4	GB, IE
		Propane G31	37 mbar			0.392				
Flue Outlet Size = Ø 175 mm										
Gas Inlet Connection Size = Ø 8 mm										
Minimum Flue Specification = T250 / N2 / 0 / D / 1										
Maximum Flue Temperature = 120°C										

Weight	Appliance Only	Profil	Bauhaus	Steel
Studio 1	36.5kg	3.6kg	3.6kg	18.5kg
Studio 2	71kg	6.5kg	6.5kg	21kg
Studio 3	94.2kg	8.0kg	8.0kg	24kg

Installation Instructions

Technical Specification

PACKING CHECKLIST

Qty Description	Fixing Kit containing:
1 Decorative Cover Plate	1 x Instruction Manual
1 White Stone Chippings	7 x Wood Screws
2 Adjustable Legs	7 x Rawl Plugs
	1 x Handset
	4 x AA batteries
	1 x PP3 batteries
	1 x Wall Box
	1 x Touchpad/ Wall Plate
	1 x Battery Holder

Appliance Dimensions			
Dimension	Studio 1	Studio 2	Studio 3
A	175	175	175
B	250	250	325
C	207	307	465
D	635	835	1225
E	660	860	1250
F	130	130	130
G	187	187	187
H	334	334	334
I	133	133	133
J	130	130	130
K	187	187	187
L	50	50	50
M	300	300	300
N	817	817	1217
O	664	864	1254
All dimensions in mm.			

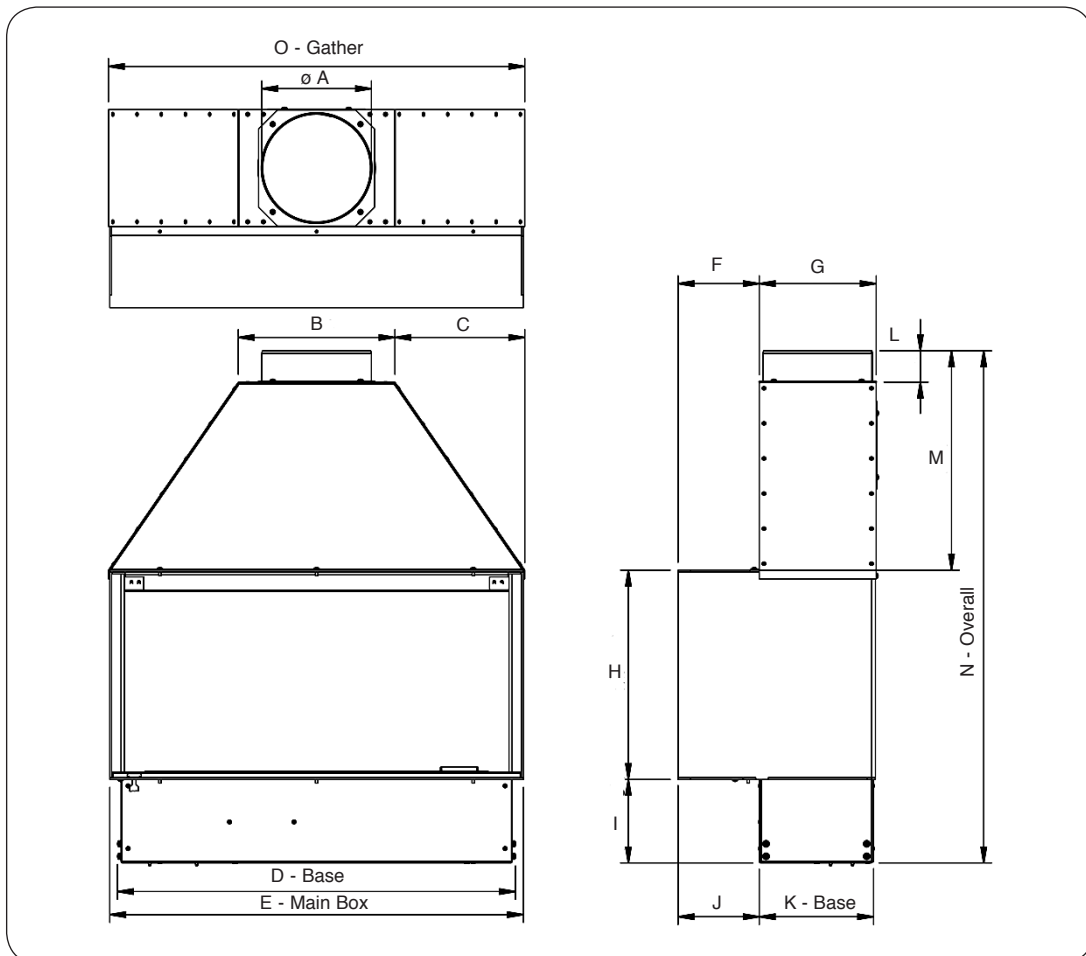

Installation Instructions

Technical Specification

Steel Fronts					
Model	A	B	C	D	E
Studio 1	1118	478	654	328	13
Studio 2	1354	508	854	328	13
Studio 3	1844	528	1244	328	13

Glass Fronts					
Model	A	B	C	D	E
Studio 1	1264	528	650	324	17
Studio 2	1500	528	850	324	17
Studio 3	1990	528	1240	324	17

Verve Fronts					
Model	A	B	C	D	E
Studio 1	1264	528	650	324	54
Studio 2	1500	528	850	324	54
Studio 3	1990	528	1240	324	54

Profil Fronts					
Model	A	B	C	D	E
Studio 1	750	426	664	329	12.5
Studio 2	950	426	864	329	12.5
Studio 3	1340	426	1254	329	12.5

Bauhaus Fronts					
Model	A	B	C	D	E
Studio 1	764	439	654	329	28
Studio 2	964	439	864	329	28
Studio 3	1354	439	1254	329	28

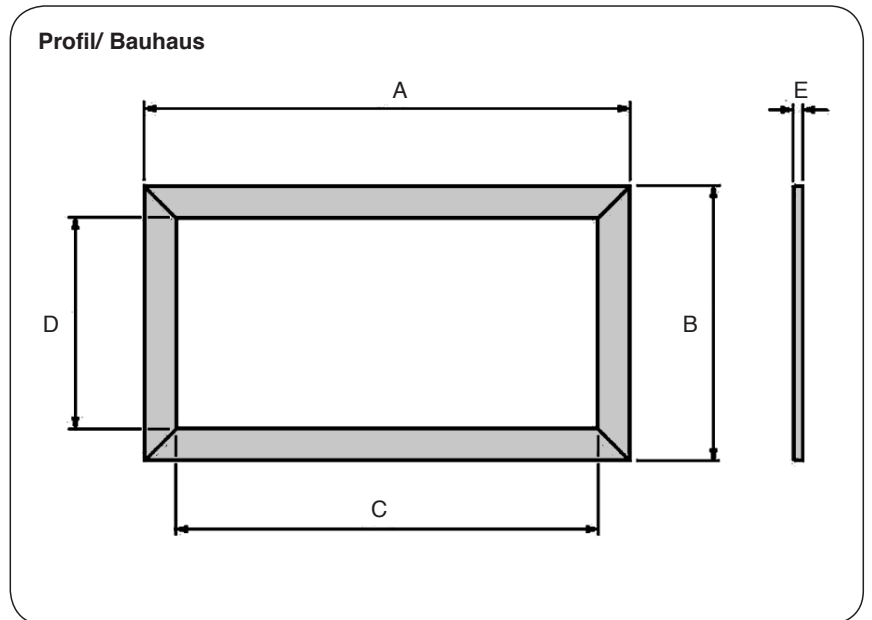
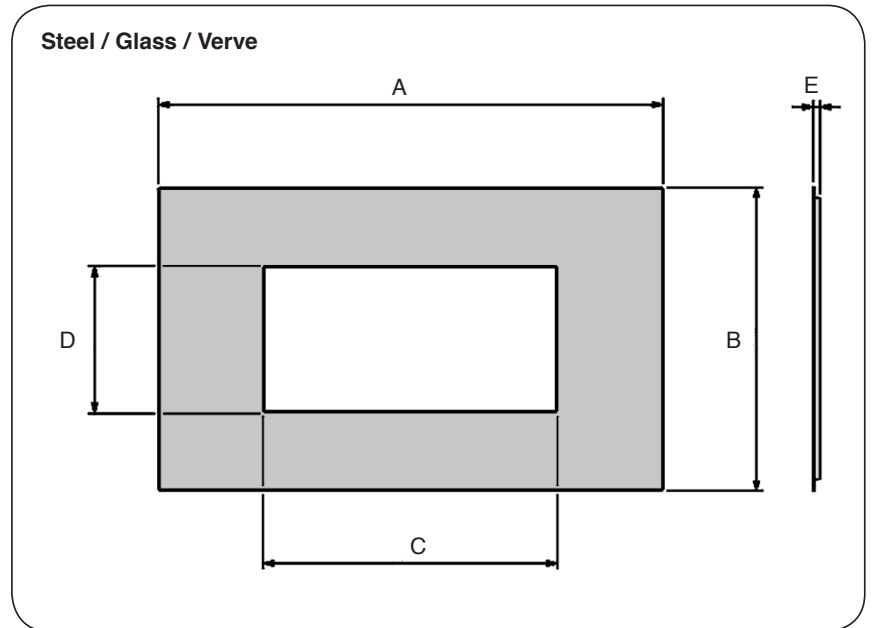

Installation Instructions

Site Requirements

1. Flue & Chimney Requirements

1.1 There are two main Chimney Types:

Prefabricated Flues

All studio fires can be fitted to prefabricated 7" min wall flue systems suitable for gas. In all instances the flue gather must be used.

Class 1 Brick Built Flues

STUDIO 1 (WITHOUT GATHER)

Can be fitted without the optional flue gather if the chimney is sound.

STUDIO 1 (WITH GATHER)

If the optional gather is used it must be connected to a 7" flexible flue liner. If sufficient access is available, then it can be fitted without a liner, creating a smooth transition between the top of the gather and the flue.

STUDIO 2 & 3 (WITH GATHER)

It is possible to install the Studio 2 and 3 into a Class 1 brick built flue. This, however, requires the front wall and structure of the chimney breast to be extensively cut away to provide enough width to fit the Studio and to give access to the top of the gather for:

- Connecting a 7" flexible flue liner suitable for gas.
- Creating a smooth transition between the top of the gather and the flue.

CAUTION: This type of installation must only be attempted by chimney specialists.

STUDIO 2 (WITHOUT GATHER)

Gazco recommends our flue gather supplied with the Studio 2, but if the installer is confident the chimney's draw is sufficiently strong to clear the products of combustion from the fire without spilling (especially in the top corners), then installation without the flue gather is acceptable. Sufficient testing must be carried out prior to and after installation to ensure the Studio 2 does not spill.

Please note: Gazco cannot assume any responsibility for an installation which spills where the flue gather is not fitted.

STUDIO 3

Studio 3 must be fitted with the supplied flue gather in all installations, including the prefabricated 7" twin wall flue; see Technical Specification, Packing Checklist page 8 for dimensions.

1.2 The minimum effective height of flue/chimney must be 3 metres (10ft).

- 1.3 The chimney or flue must be free from obstruction: Check damper plates are removed or secured fully open and no restrictor plates fitted.
- 1.4 Sweep the chimney immediately before installation unless you can see it is clean and unobstructed through its entire length.
- 1.5 Ensure there is a smooth tapered transition from the fireplace opening into the chimney or flue, (Studio 1 only).
- 1.6 Check the flue pull prior to installation:
 - Place a smoke pellet into the flue/chimney opening to test smoke is drawn into the opening.
 - If there is no definite draw, pre-heat the chimney for a few minutes and re-test.

2. Location of Fire

Combustible Materials

- 2.1 **THIS APPLIANCE IS NOT SUITABLE FOR INSTALLATION ONTO A COMBUSTIBLE WALL.** All combustible materials must be removed from the area shown in Diagram 1.

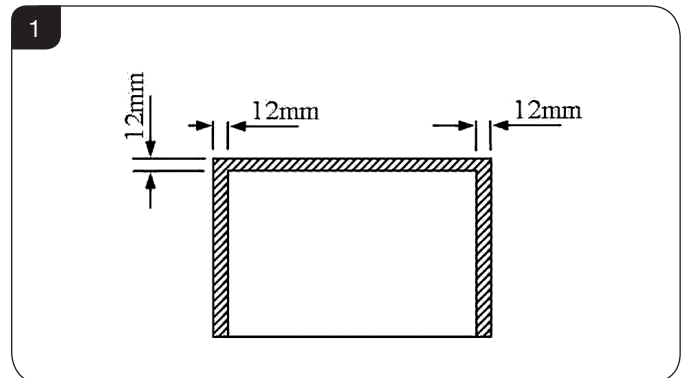

- 2.2 The appliance must stand on a non-combustible base at least 12 mm thick.
- 2.3 The appliance must be fitted into a non-combustible opening.
- 2.4 The hearth must extend 100mm to the front, 150mm to each side of the fire and stand 50mm high at its edge (F - Diagram 2 or 3).
- 2.5 Any combustible shelf positioned above the appliance must be a maximum of 150mm in depth (working out from the wall) and a minimum of 300mm high above the appliance.

Installation Instructions

Site Requirements

Wall Location without Frame

- 2.6 Minimum dimensions for a hole in the wall installation without a frame are given in Diagram 2.

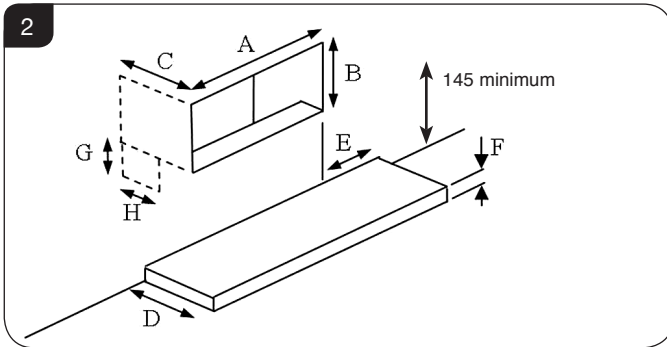

Dimension	Studio 1	Studio 2	Studio 3
A	665	865	1255
B	338	338	338
C	315	315	315
D	100	100	100
E	150	150	150
F	50	50	50
G	133	133	133
H	187	187	187

Wall Location with Frame

Note: If you are not using a Gazco supplied frame, make sure any granite, marble or other materials decorating the front of the opening (if used) do not reduce the minimum opening sizes shown; this might make servicing difficult.

- 2.7 Increase the size of the opening for a Studio with frame, Diagram 3.

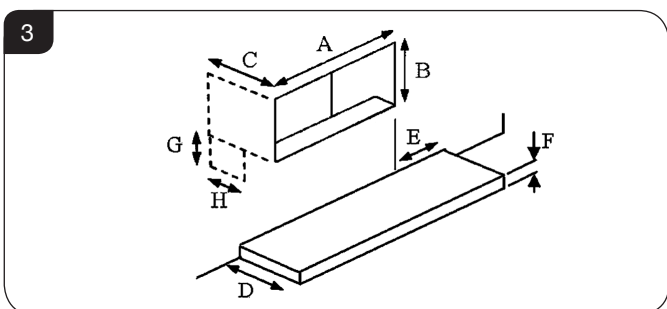

Dimension	Studio 1	Studio 2	Studio 3
A	675	875	1265
B	348	348	348
C	315	315	315
D	100	100	100
E	150	150	150
F	50	50	50
G	133	133	133
H	187	187	187

Flat TV

- 2.8 To install a television or screen above the fire, make sure it is positioned a minimum of 450mm above the appliance.

Complete commissioning tests in full ensuring fire is clearing its products of combustion.

3. Gas Supply

- 3.1 Check the local gas distribution to be sure the gas type and pressure are compatible for this fire and adjust accordingly.
- 3.2 Check the supply can deliver the right amount of gas according to the rules in force.
- 3.3 A factory-fitted isolation device incorporated into the inlet exists. No further isolation device is required.
- 3.4 The gas supply enters the fire through a silicon panel on the floor at the back/left. Slit with a sharp knife before bringing through the supply pipe, see Diagram 4.

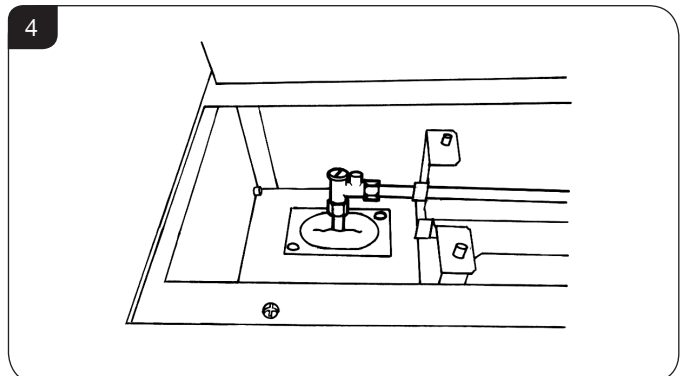

4. Ventilation

IMPORTANT: Ensure any national ventilation requirements are taken into account during installation of the appliance.

Studio 1

- 4.1 The Studio 1 has a nominal input not exceeding 7.0kW and does not normally require any additional permanent ventilation.

Studio 2 & 3

- 4.2 There must be a minimum of 100cm² permanent purpose built ventilation. There may be insufficient natural ventilation if spillage is detected during commissioning and adding more ventilation may be necessary.

FOR REPUBLIC OF IRELAND REFER TO THE RULES IN FORCE FOR VENTILATION REQUIREMENTS.

AIR VENTS MUST NOT BE RESTRICTED.

Installation Instructions

1. Safety Precautions

- 1.1 For your own and other's safety, you must install this stove according to local and national codes of practice. Failure to install the stove correctly could lead to prosecution. **Read these instructions before installing and using this appliance.**
- 1.2 These instructions must be left intact with the user.
- 1.3 Do not attempt to burn rubbish on this appliance.
- 1.4 Keep all plastic bags away from young children.
- 1.5 Do not place any object on or near to the appliance and allow adequate clearance above the appliance.

IF THE APPLIANCE IS EXTINGUISHED OR GOES OUT IN USE, WAIT 3 MINUTES BEFORE ATTEMPTING TO RELIGHT THE APPLIANCE.

i **IMPORTANT: REFER TO DATA BADGE AND TECHNICAL SPECIFICATION AT THE FRONT OF THE MANUAL TO ENSURE THE APPLIANCE IS CORRECTLY ADJUSTED FOR THE GAS TYPE AND CATEGORY APPLICABLE IN THE COUNTRY OF USE.**

FOR DETAILS OF CHANGING BETWEEN GAS TYPES REFER TO SERVICING, SECTION 10, REPLACING PARTS.

Unpacking

- 1.6 Remove the appliance from its packaging, and check that it is complete and undamaged.
- Put the loose ceramic parts to one side so that they are not damaged during installation.

2. Installation of the Gas Supply

NATURAL GAS @ 20mbar	PROPANE @ 37mbar BUTANE @ 29 mbar
8700CHEC	P8700CHEC
8701CHEC	P8701CHEC
8702CHEC	P8702CHEC

- 2.1 Check the local gas distribution to be sure the gas type and pressure are compatible for this fire and adjust accordingly. See table above.
- 2.2 Check the supply can deliver the right amount of gas according to the rules in force.
- 2.3 Soft copper tubing and soft soldered joints must be no closer than 50mm (2") to the underside of the burner.
- 2.4 An isolation device is provided with this fire.
- 2.5 Purge all gas pipes of any debris before connecting the fire.

- 2.6 Diagram 1 shows the location and position of the gas inlet pipe. Its height varies depending on type of installation.

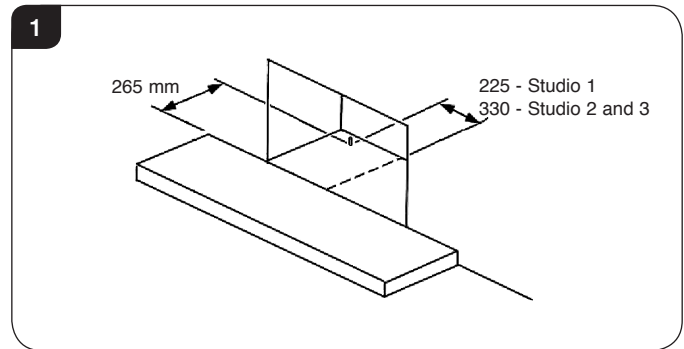

3. Installation of the Fire

- 3.1 Refer to the Flue and Chimney Requirements (1.1) under Site Requirements for site options for type of Studio.
- Fitting gather (Studio 1 optional extra)**
- 3.2 Place the gather on top of the fire and secure from within the appliance with six screws, see Diagram 2.

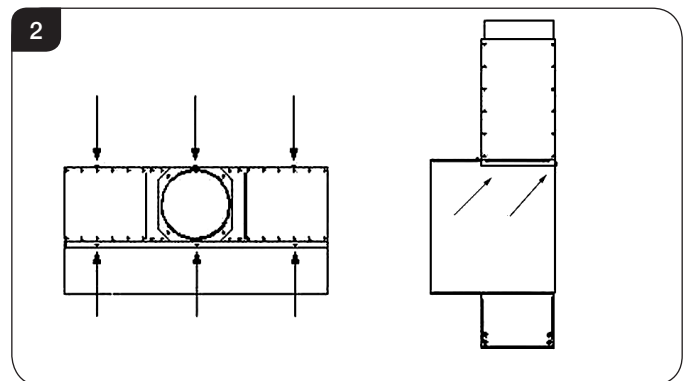

4. Installing into a Masonry Chimney

i **STUDIO 1 ONLY**

NOTE: WHERE A GATHER IS USED, FIT BEFORE FITTING THE SUB-FRAME, SEE DIAGRAM 3.

NOTE: TO PREVENT PAINT DAMAGE AND RUST OCCURRING, WHEN PLASTERING AROUND THE APPLIANCE PROTECT THE EDGES OF THE FIREBOX WITH MASKING TAPE OR SIMILAR PREVENTION METHODS.

Installation Instructions

4.1 Fit the sub-frame (if purchased) before installation.

Fitting the Sub-Frame:

4.2 The sub-frame is found in the same pack as the frame.

Note: The tabs marked A in Diagram 3 must be folded up into position before fitting.

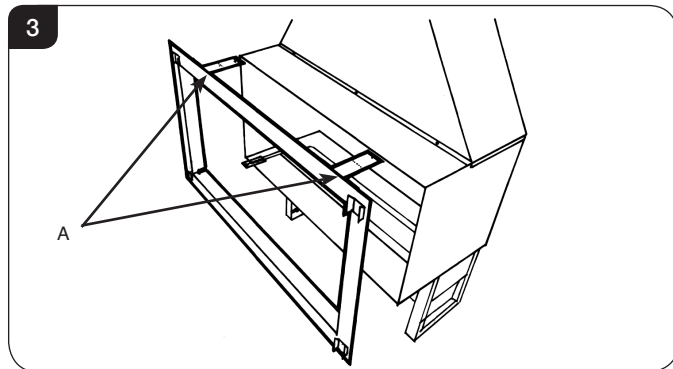

4.3 Position the sub-frame at the front edge of the frame and slide forward.

4.4 Secure using the four screws, see Diagram 4.

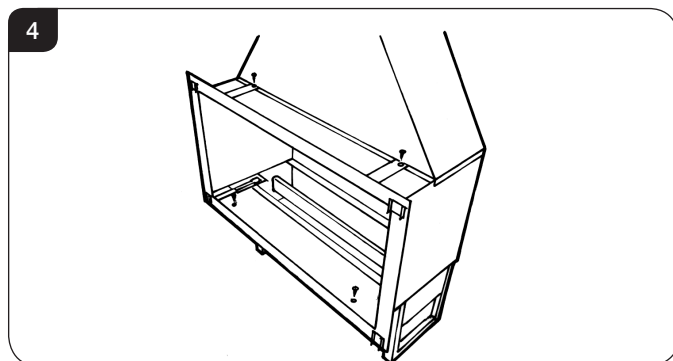

Checking Fireplace Opening

4.5 Check the fireplace is correct size or modified for this fire.

4.6 Check the leg adjustment referring to see Diagram 5.

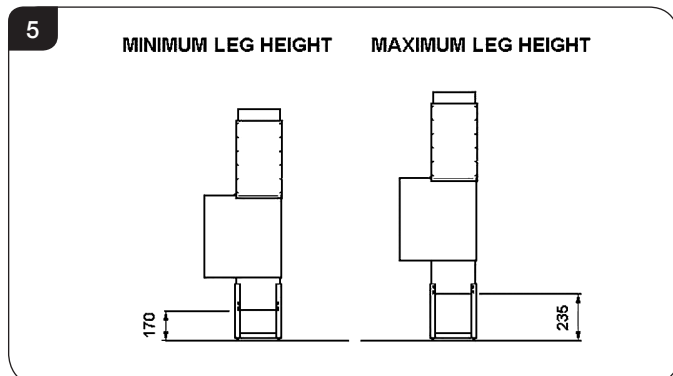

Check the height of the fireplace for the position of the fire.

If the height needs raising any built-in fireplace gather may need reforming.

Where there is no built-in gather leave 80mm between the fire and the top of the fireplace.

4.7 If the installation needs a flue liner, a flue gather must be fitted. The fireplace may need altering to allow for the gather.

Fitting the Fire in an Enclosed Recess

4.8 The design of Studio 1 allows the front opening of the fireplace to be bricked up below the fire.

4.9 To fit the fire into this space:

- Check the recess is the correct size, see Location of Fire in Site Requirements.
- Make sure the gas inlet has been provided.
- Separate the lower burner compartment from the firebox.

4.10 To detach the lower burner compartment remove three screws and wing nuts, see Diagram 6 then pass the burner compartment up through the firebox.

If fitting with a frame, the front of the chimney breast will need plastering BEFORE fitting the appliance.

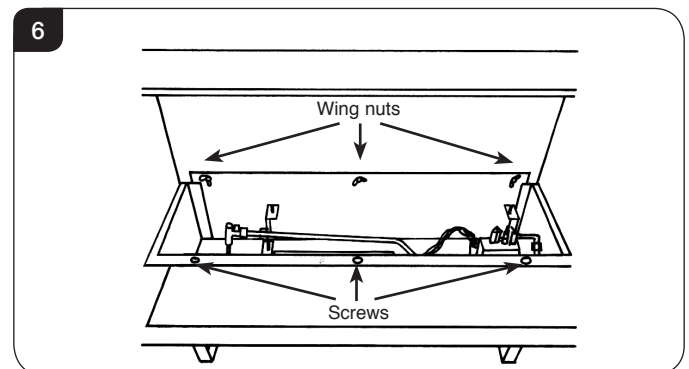

4.11 Take the separated firebox through the fireplace opening. Secure the four rear and three lower holes using rawl plugs and screws provided, see Diagram 7.

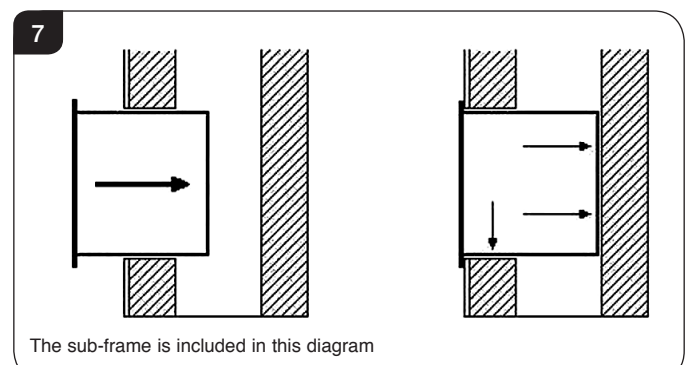

The sub-frame is included in this diagram

Installation Instructions

- 4.12 Pass the lower burner compartment back down through the firebox. Let the gas inlet through the bottom of the box, see Diagram 8.

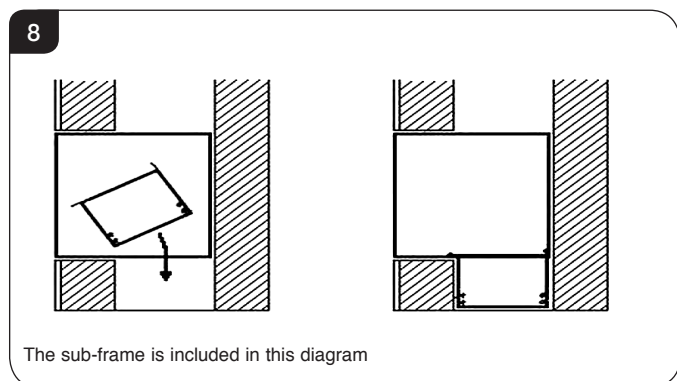

- 4.13 Re-fix using the three screws and three wing nuts.
4.14 Make good the wall around the firebox.

5. Installing into a Studwork Chimney Breast - All Studios

5.1 DISTANCE TO COMBUSTIBLE MATERIAL

COMBUSTIBLE PARTS OF THE STUDWORK MUST BE KEPT BEYOND THE MINIMUM DIMENSIONS SHOWN IN DIAGRAM 9. EVEN IF THE FRAMEWORK IS PROTECTED BY NON-COMBUSTIBLE MATERIAL, YOU MUST MAINTAIN THESE DIMENSIONS, SEE DIAGRAM 9.

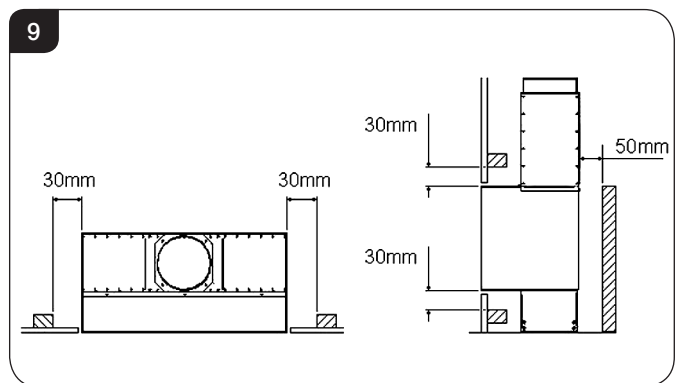

- 5.2 Decide on the height of the fire by adjusting the legs and/or raising the floor level beneath the fire.
5.3 Fit the flue gather and install a twin-wall metal flue system to the fire.
5.4 Install the gas inlet pipe.

Stud-work and Non-combustible Lining

- 5.5 Build the stud-work frame around the fire to the correct size.
— Line the opening with 12mm thick non-combustible material.
5.6 A batten is required across the back of the studwork chimney breast to secure the fire in place.

Attach the fire to the batten through the fixing holes in the back panel, see Diagram 10.

- 5.7 Protect the batten with 12mm non-combustible material and secure the fire through fixing holes in the front ledge, see Diagram 10.

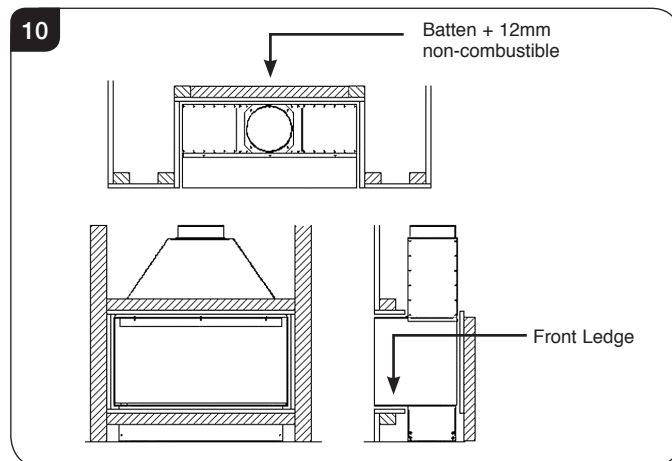

- 5.8 Leave a 5mm gap all around the front edge of the appliance where a frame is to be fitted, see Diagram 11.

The upright studding either side of the fire must line up with the sub-frame fixing holes when fitting a frame.

Sub-frame and Frame Fitting

- 5.9 The front of the chimney breast must be plastered before fitting the sub-frame.

NOTE: TO PREVENT PAINT DAMAGE AND RUST OCCURRING, WHEN PLASTERING AROUND THE APPLIANCE PROTECT THE EDGES OF THE FIREBOX WITH MASKING TAPE OR SIMILAR PREVENTION METHODS.

Diagram 11 shows the increase in opening size for a fitted Frame and in this type of installation.

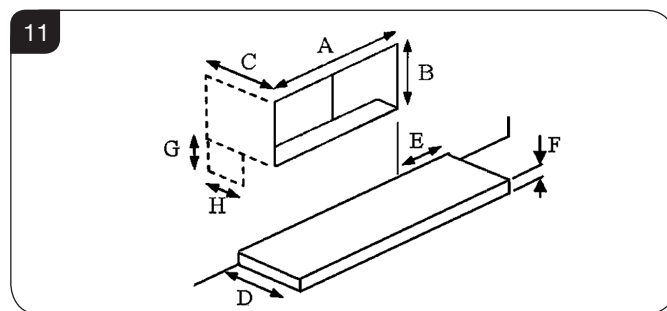

Dimension	Studio 1	Studio 2	Studio 3
A	675	875	1265
B	348	348	348
C	315	315	315
D	100	100	100
E	150	150	150
F	50	50	50
G	133	133	133
H	187	187	187

Installation Instructions

- 5.10 Fit the sub-frame by sliding it over the front edge of the fire till flush and secure into the wall and studwork through the holes in the flange, see Diagram 12.

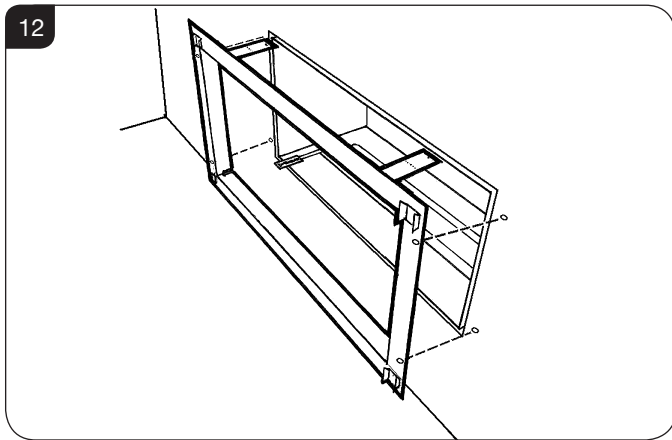

- 5.11 Drop the frame onto the four hooks on the sub-frame, see Diagram 13.

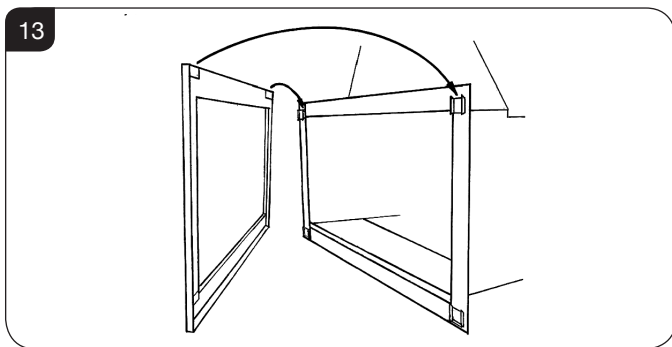

6. Wall Box Installation

The Wall Box must be fitted with the appliance as it is where the batteries are located. Do not place the batteries inside the appliance.

- 6.1 Decide on the position for the wall box containing batteries and wall switch.
6.2 Connect the wire from the appliance to the battery pack, see Diagram 14.

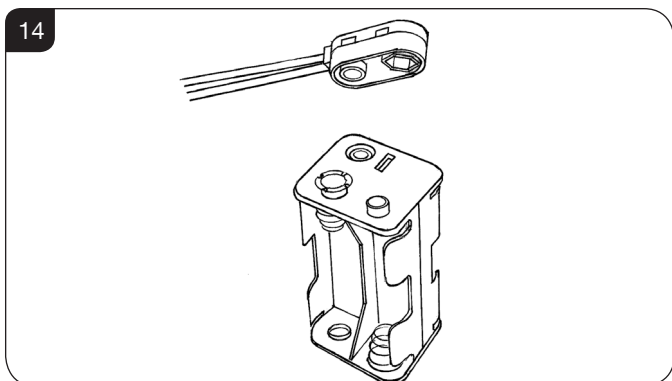

- 6.3 Connect the wire from the appliance to the touchpad/connector, see Diagram 15.

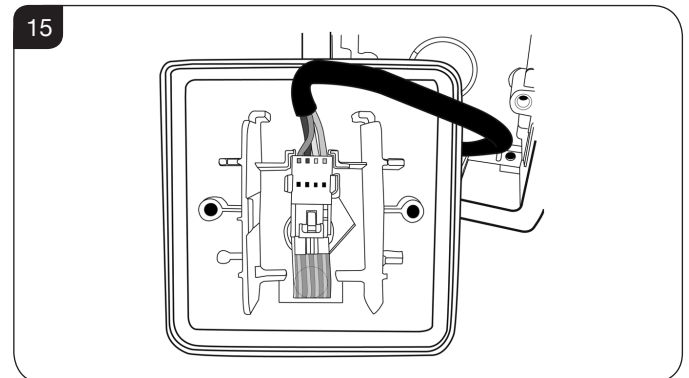

- 6.4 Correctly position the four new AA size batteries into the battery holder and re-assemble the battery holder as shown in Diagram 16.

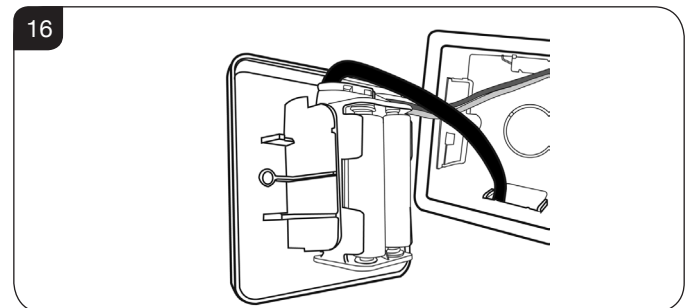

- 6.5 Secure the wall plate with the touchpad attached to the wall box, see Diagram 17.

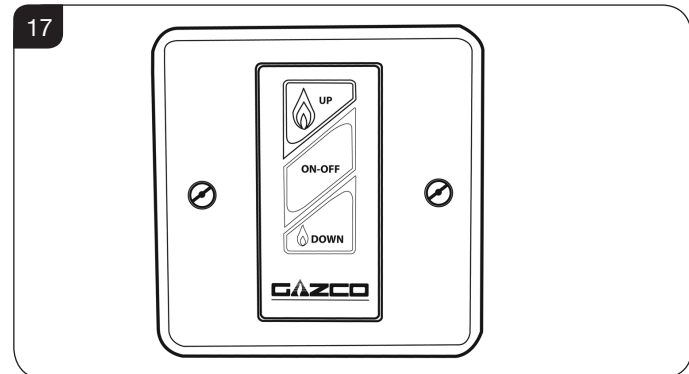

i **IMPORTANT**
The wall plate must be installed using a non-metallic mounting box, please ensure that the plastic dry lining box is used wherever possible. If it is intended to install the wall plate into masonry it is possible to drill through the rear of this box and secure in position using wall plugs and screws although a small amount of finishing work will be required to cover the plastic side securing tags. Alternatively a standard 47mm deep pattress box can be used to surface mount the wall plate.

PLEASE ENSURE NO WIRES ARE TRAPPED BEFORE REPLACING THE WALL PLATE. THE LEAD IS EASILY DAMAGED.

Installation Instructions

7. Finishing Installation

- 7.1 Fit the loose back panel onto the studs at the back of the fire, see Diagram 18.

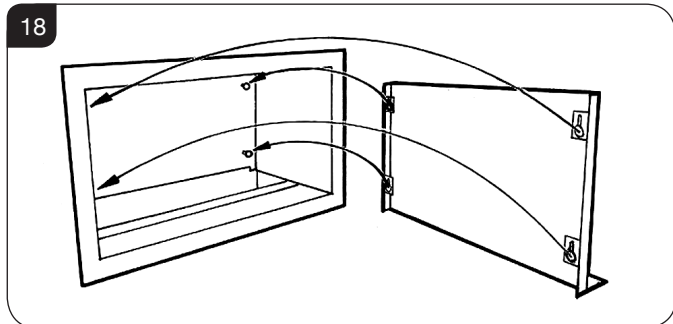

- 7.2 Connect the gas supply to the isolation device with 8mm pipe.

- 7.3 Remove test point screw and attach a pressure gauge to the test point.

Turn on the gas.

Burner Installation

- 7.4 Fit the burner tray into the appliance. Lower the right hand side so that the pilot cut-out locates on the pilot assembly, see Diagram 19.

- 7.5 Carefully lower the left hand end of the burner tray into position making sure that the central venturi tube locates over the main gas injector.

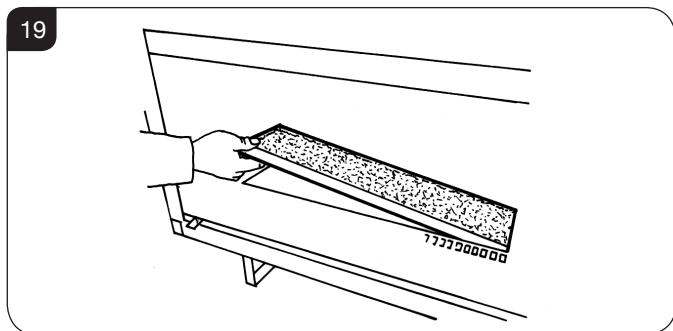

Pressure Checks for All Studios

- 7.6 Route the pressure gauge hose to the left under the burner tray and check for leaks.
- 7.7 Light the fire, set it to maximum and check the pressure corresponds to the data badge.
- 7.8 Turn the gas off.
Replace test point screw.
Turn the gas on and check screw for leaks.

Stone Chippings/ Glass Fuel Effect

- 7.9 Spread the fuel effect over the burner and arrange until level with the rim of the burner tray.

**DO NOT OVER FILL THE BURNER TRAY.
TAKE CARE NOT TO SPILL EFFECT INTO THE PILOT AREA.**

- 7.10 Fit the decorative stainless steel front plate, see Diagram 20. Make sure the rear downward fold locates between the back edge of the burner tray and the rear panel.

MAKE SURE THAT THE SMALL CUT OUT ON THE RIGHT OF THE FRONT FACE OF THE DECORATIVE PANEL LOCATES OVER THE INFRARED SENSOR.

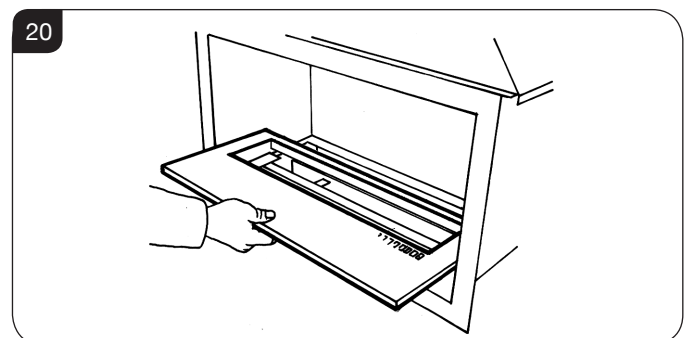

Black Granite Panels (optional)

- 7.11 Before the granite back and side panels can be fitted: unscrew and remove the two metal plates inside the firebox, see Diagram 21.

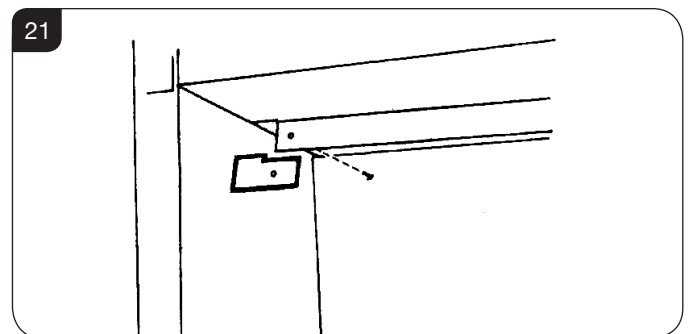

Installation Instructions

- 7.12 Place the granite rear panels onto the metal ledge of the back panel and fit neatly together in the middle.
- 7.13 Position the retaining clip for the granite as shown in Diagram 22. The clip holds the two granite pieces flat against the metal back panel.

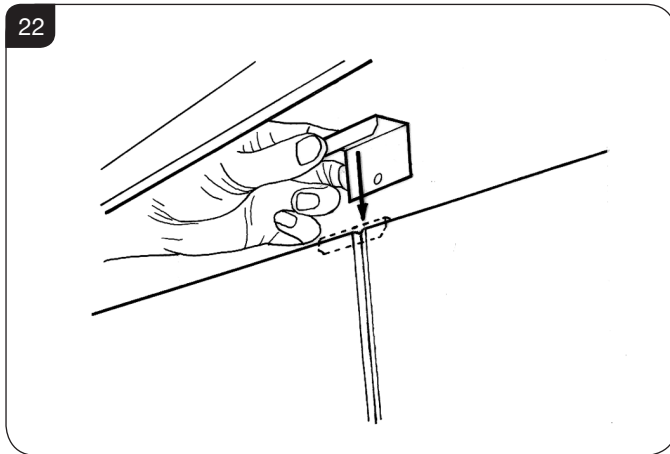

- 7.14 Slide in the two side panels.

You must be able to remove the side panels to service the fire.

8. Lighting the Appliance

There are two ways of lighting the Studio:

1. By remote control.
2. Using the appliance touch pad.

Remote Control

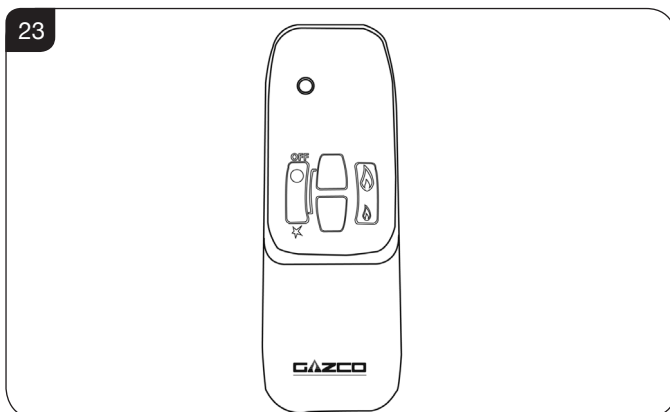

- 8.1 **To light the appliance** press the LOWER section of the LEFT hand button and the UP button simultaneously. An audible beep will be heard (the lighting sequence can take up to 30 seconds).

The pilot will light along with the main burner on high setting.

8.2 Adjusting the Flame Height

The flame height of the main burner can be:

- **Increased** by holding down the LOWER section of the LEFT hand button and the UP button simultaneously.
- **Decreased** by one height stage by pressing the DOWN button once.
- Hold the DOWN button to decrease to minimum. At the lowest point the appliance goes into standby mode where only the pilot is lit.

8.3 Turning the appliance Off

Press the OFF button to extinguish the appliance.

Touch Pad Control

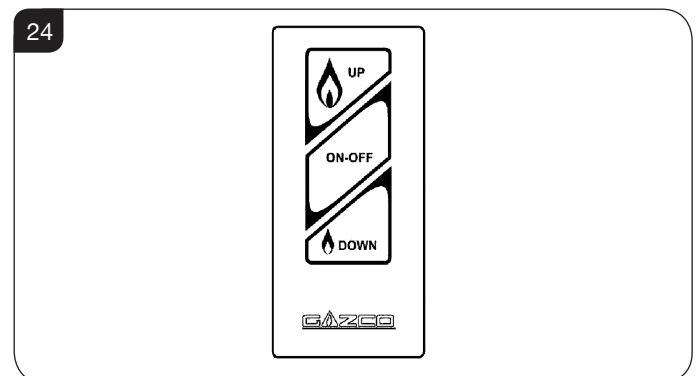

- 8.4 **To light the appliance** press the ON-OFF button (up to 30 seconds).

8.5 Adjusting the Flame Height

- Press the UP button to increase the flame height.
- Press the DOWN button to decrease the flame height. At the lowest point it goes to 'standby mode', (only pilot lit).

8.6 Turning the appliance Off

Press the ON-OFF button to turn the appliance off.

Commissioning

1. Commissioning

- 1.1 Upon completion of the installation a smoke test must be carried out.
- 1.2 To prepare a smoke match test:
 - Close all doors and windows in the room.
 - Check all controls.
 - Allow the fire to burn on maximum for 5 minutes.
 - Use a smoke match to test for spillage of flue products by passing a lighted smoke match along the top front edge, inside the opening or canopy, see Diagram 1.

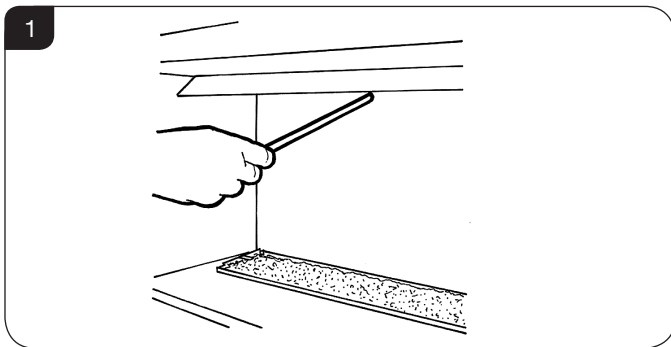

- 1.3 Run the fire for a further 10 minutes and repeat the test if there is any spillage.
- 1.4 Where there are extractor fans in the room or adjacent rooms, repeat the test with the fans running on maximum. **IF SPILLAGE PERSISTS, DISCONNECT THE FIRE AND SEEK EXPERT ADVICE.**

You must record the installation details on the Appliance Commissioning Checklist on page 3.
- 1.5 Complete the Commissioning Checklist at the front of this manual covering:
 - Flue checks
 - Gas checks
 - Fuel Effect layout - flame picture

For working pressure test, use the access panel at the gas connection ensuring the burner is in position. Refer to Replacement Parts, Section 1.
- 1.6 Upon completion of the commissioning and testing of the installation and correct operation of the appliance, the installer must instruct the user how to operate the appliance.
- 1.7 Guide the user through the User Instructions paying particular attention to:
 - a) Regular servicing (Section 9 of the User Instructions).
 - b) Ventilation (Section 10 of the User Instructions) - point out the ventilation positions where applicable.
 - c) Hot surfaces (Section 12 of the User Instructions).

d) How the appliance works with the touch pad control (Section 2 of the User Instructions).

e) How the appliance works with the remote control handset and the modes of operation (Section 2 of the User Instructions).

f) What to do if the appliance fails to operate (Section 13 of the User Instructions).

Servicing Instructions

Servicing/Fault Finding Charts

1. Servicing Requirements

This appliance must be serviced at least once a year by a competent person.

All tests must be carried out in accordance with the current GasSafe recommendations.

1.1 Before Testing:

- Conduct a gas soundness test for the property ensuring there are no leaks before servicing.
- Check the operation of the appliance before testing.

1.2 Special checks:

- Clean away lint or fluff from the pilot.
- Clean away lint or fluff from under the burner.
- Check the spark gap on the pilot is correct.

1.3 Correct any faults found during the initial test.

1.4 Re-commission the appliance in accordance with Commissioning Procedures of these instructions.

1.5 Advise the customer of any remedial work undertaken.

REPLACE BATTERIES BEFORE ATTEMPTING TO RECTIFY ANY FAULTS.

**IF THE APPLIANCE DOES NOT WORK, BUT HAS WORKED IN THE PAST:
CHECK THE EMERGENCY SHUT OFF SWITCH, IS SWITCHED ON, SEE USER SECTION 2.**

ELECTRONIC CONTROL VALVE FAULT ANALYSIS		
Symptom	Cause	Remedy
3 short beeps from control	Batteries low in appliance	Replace appliance batteries
No ignition, 5 seconds continuous tone (there can be several short beeps before)	1. ON/OFF switch is in OFF position 2. Loose/damaged wire	1. Move switch to ON position 2. Tighten replace relevant wire
No ignition, no tone, motor turned slighted when operated	Receiver board damaged	Replace receiver
No pilot flame and control continues to spark	Thermocouple circuit wired incorrectly	Correct wiring
Pilot lights, control continues to spark, valve shuts down after 10-30 seconds	1. No spark at pilot burner 2. Loose/damaged wire	1. Rectify spark at pilot burner 2. Check interrupter and wires

Servicing Instructions

Servicing/Fault Finding Charts

IGNITION FUNCTIONAL CHECK 1

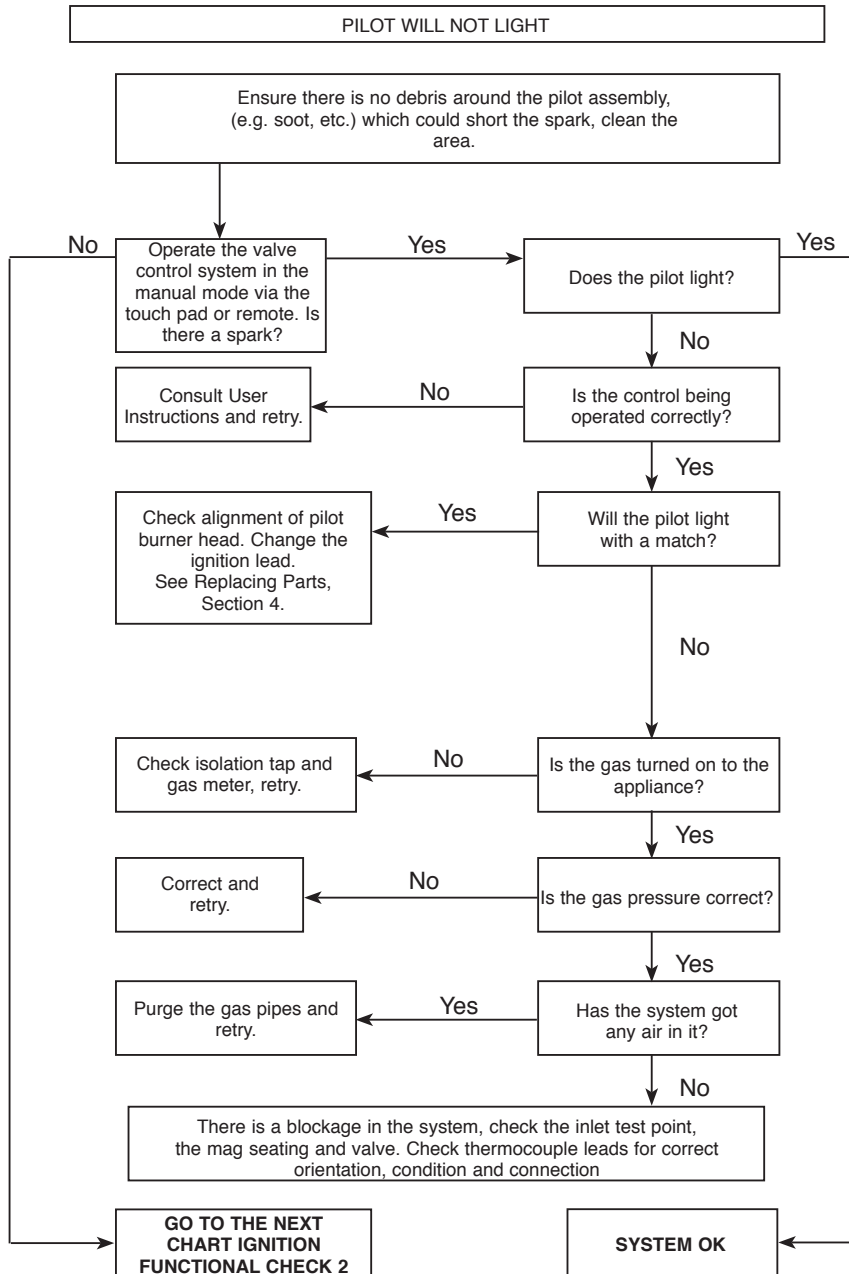

Servicing Instructions

Fault Finding Charts

FLAME FAILURE FUNCTIONAL CHECK 3

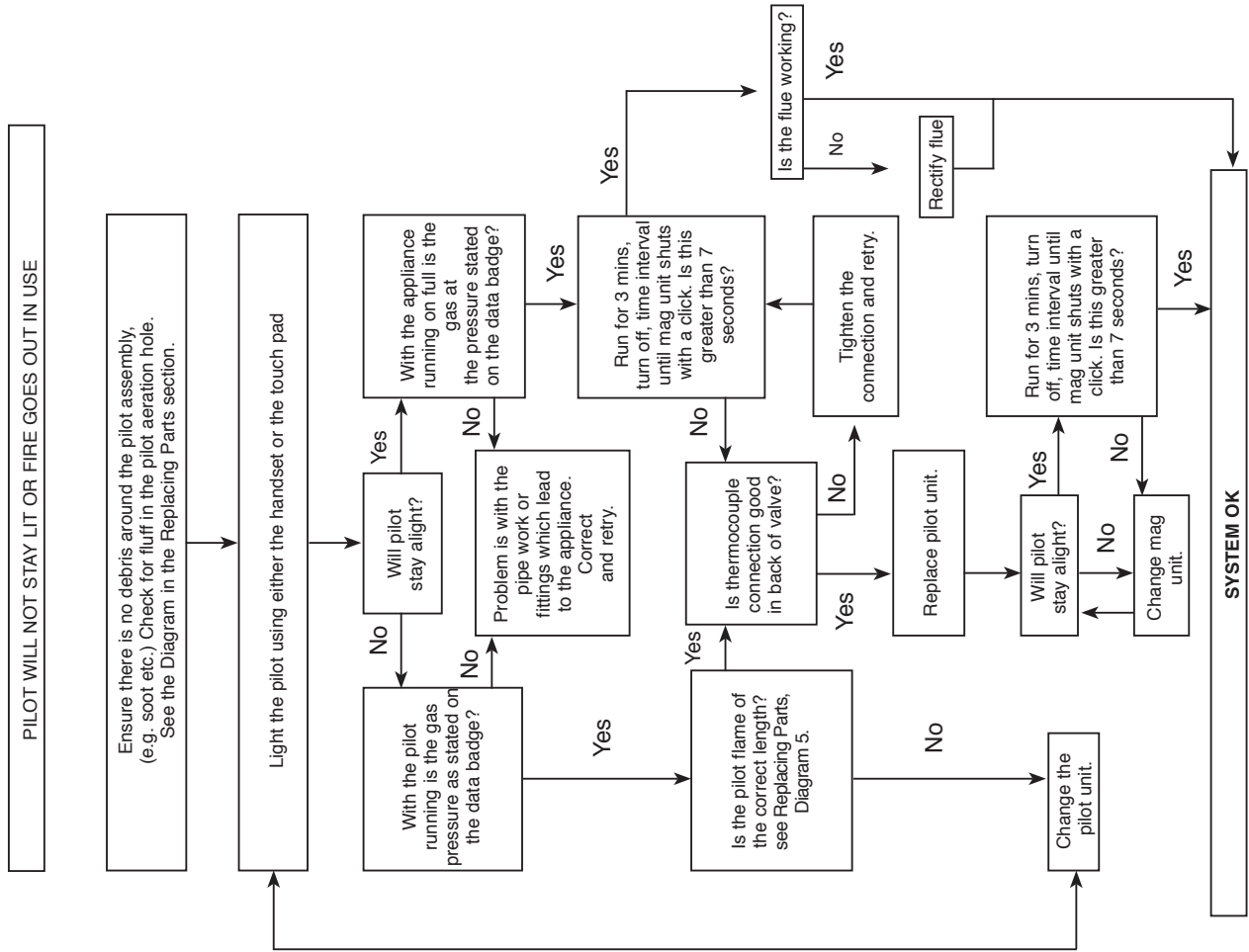

IGNITION FUNCTIONAL CHECK 2

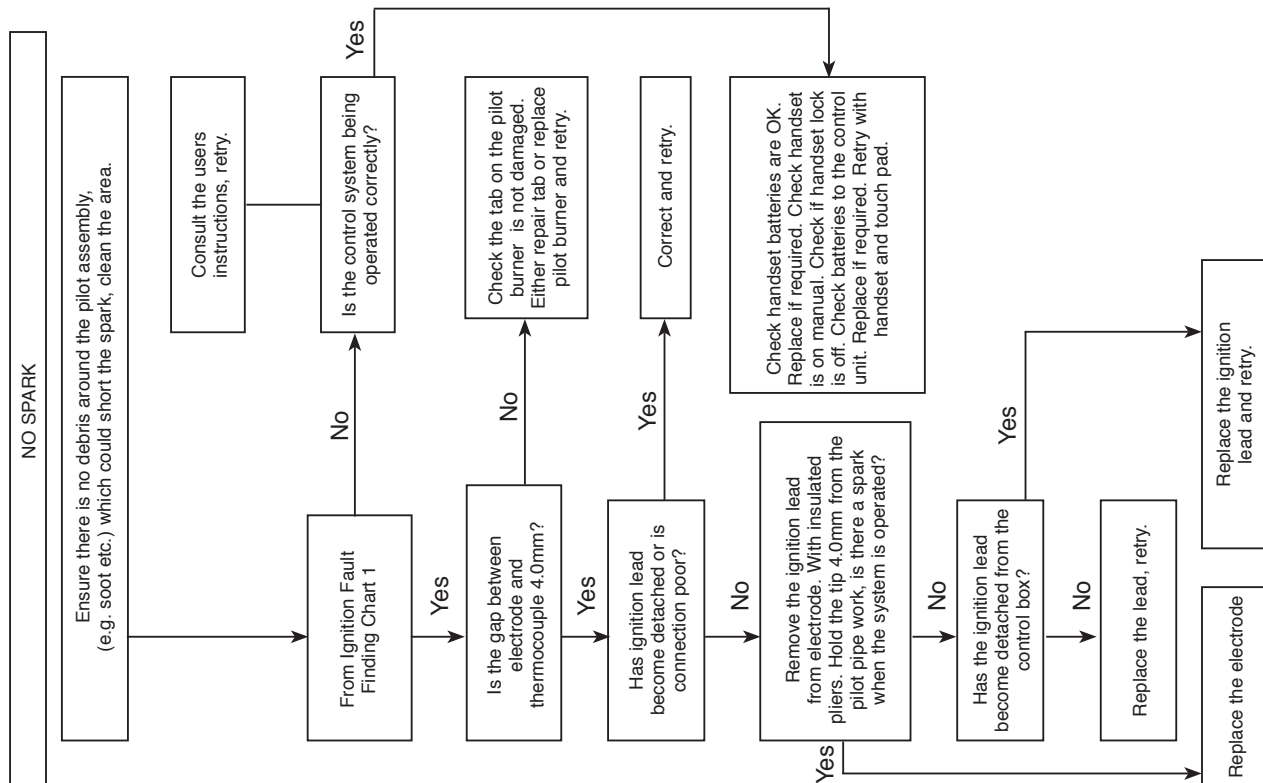

Servicing Instructions - Replacing Parts

1. General

- 1.1 All main components can be replaced without removing the appliance from its installation.

IT IS ESSENTIAL THAT THE GAS SUPPLY TO THE APPLIANCE IS TURNED OFF AT THE ISOLATION DEVICE BEFORE PROCEEDING FURTHER.

- 1.2 **DISCONNECT BATTERIES BEFORE SERVICING THE APPLIANCE.**
- 1.3 Gain access to the burner unit by removing the decorative cover plate, see Diagram 1.
- 1.4 To service the parts of this appliance first remove the side and back panels (if fitted) and the burner unit.
- 1.5 When replacing parts check all gas joints for leaks by removing the burner and attaching a manometer to the tip of the injector and turning on the gas supply.
- 1.6 Check all joints with leak detector fluid.

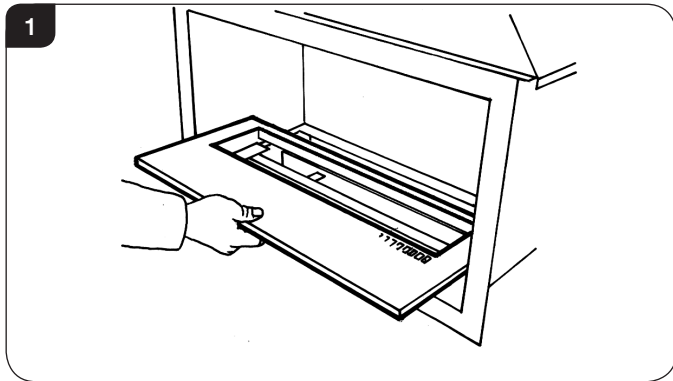

Removing Burner Tray - Studio 1

- 1.7 Slide up the small handle on the left of the tray. Use this handle and the pilot cone on the right to lift the tray clear, see Diagram 2.

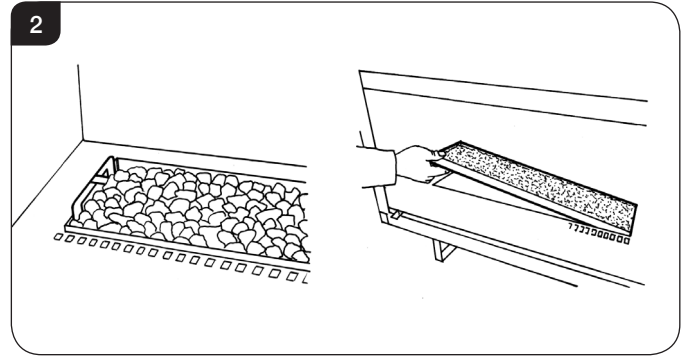

- 1.8 Empty the fuel effect into a suitable container and place the tray down.

2. Removing Control Bracket

- 2.1 Turn off the gas supply at the isolation device at the back of the fire, see Diagram 3.

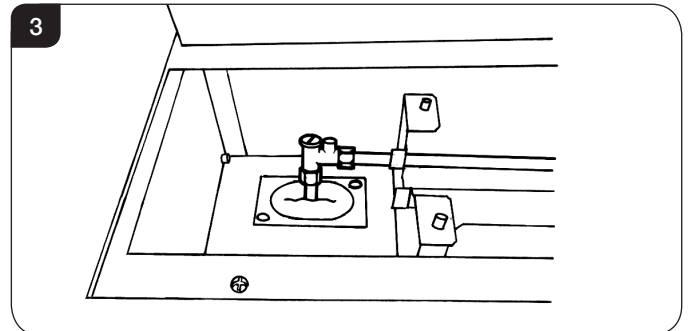

- 2.2 Disconnect the gas supply pipe leaving the isolation device on the supply pipe, not the fire.
- 2.3 Undo the 2 wing nuts holding the control bracket assembly to the base of the appliance.
- 2.4 Lift the control bracket vertically upwards to clear the fixing screws and tip the whole assembly backwards by 45 degrees.
- 2.5 Disconnect the touchpad, battery and infrared leads from the control box and lift the control bracket assembly out of the appliance.

Servicing Instructions - Replacing Parts

3. ODS Pilot Unit

Note: The pilot unit on the fire is not serviceable. Because of its complexity it is built as a complete unit. If one of the following is faulty, you must replace the whole unit:

- Pilot injector
- Ignition electrode
- Thermocouple

- 3.1 To replace the pilot unit remove the gas pipe, see Diagram 4.
- 3.2 Remove the ignition lead, see Diagram 4.
- 3.3 Undo the thermocouple connection from the back of the gas valve.
- 3.4 Undo the 2 screws securing the unit and remove the entire pilot assembly.

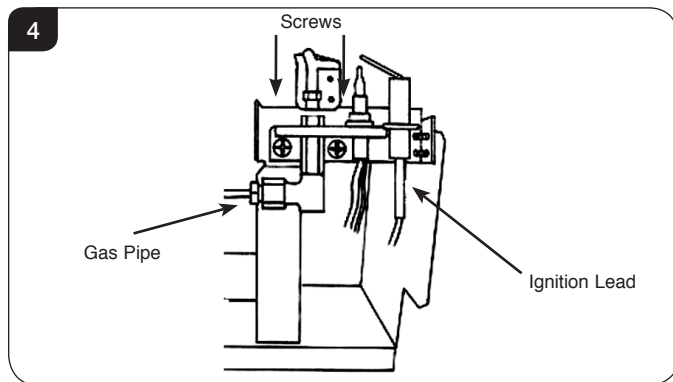

- 3.5 Replace the new pilot unit in reverse order.
- 3.6 Check that the Electrode gap and Pilot Flame are correct, see Diagram 5.

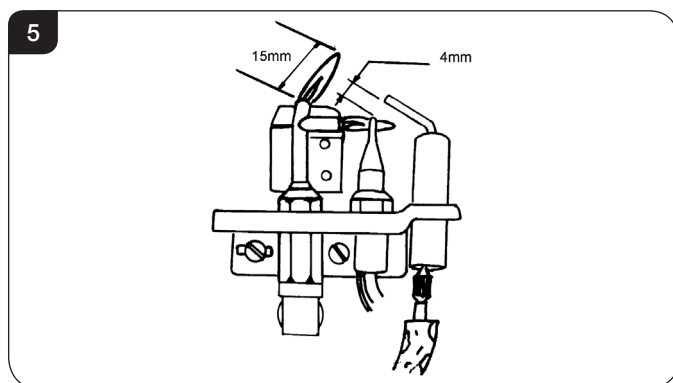

4. Ignition Lead

- 4.1 To replace the ignition lead disconnect the from the control box and remove the other end of the ignition lead from the pilot, see Diagram 4.
 - 4.2 Replace with a new ignition lead.
- Important the lead must follow the same route when it is replaced.**
- 4.3 Check the operation of the new lead.

5. Magnetic Safety Valve

- 5.1 To replace the magnetic safety valve undo the thermocouple from the interrupter block in the back of the gas valve and remove the two cables.
- 5.2 Unscrew the interrupter block from the back of the valve.
- 5.3 Undo the silver magnetic valve retaining nut on the back of the valve and gently tap out the mag valve.
- 5.4 Replace with a new unit.
- 5.5 Reassemble in reverse order and check for leaks.

6. Main Injector

- 6.1 To remove the main injector undo the nut on the main injector, see Diagram 6, arrow A and undo the lock nut securing the injector, see Diagram 6, B.
- 6.2 Remove the 2 screws securing the injector bracket, see Diagram 6, C.

When replacing the injector, it is important to ensure that it is vertical.

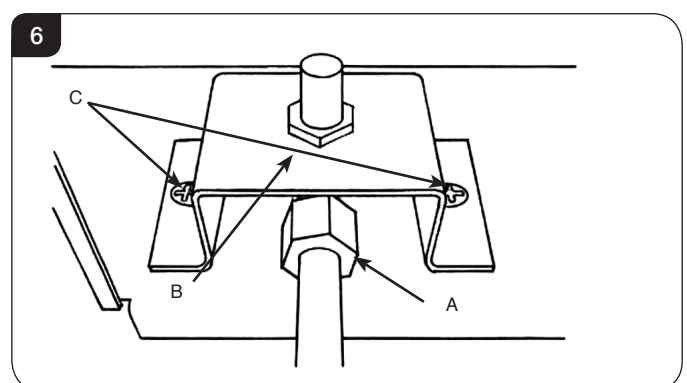

Servicing Instructions - Replacing Parts

7. Control Box

- 7.1 Remove the 2 screws securing the control box bracket, see Diagram 7.

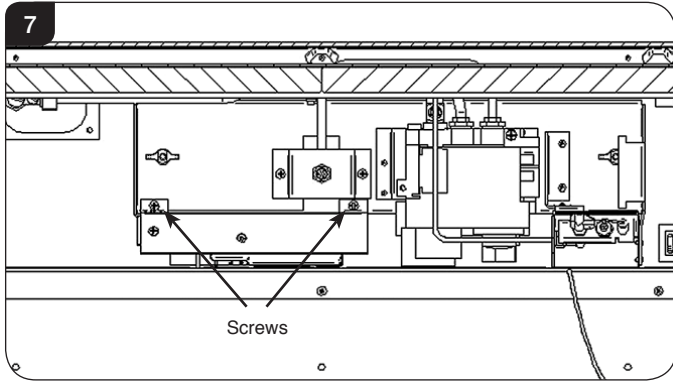

- 7.2 Remove the 2 thermocurrent cables by removing the 2 screws, see Diagram 8.
7.3 Remove the ignition lead, see Diagram 8.
7.4 Remove the eight loom wire from the control box, see Diagram 8.

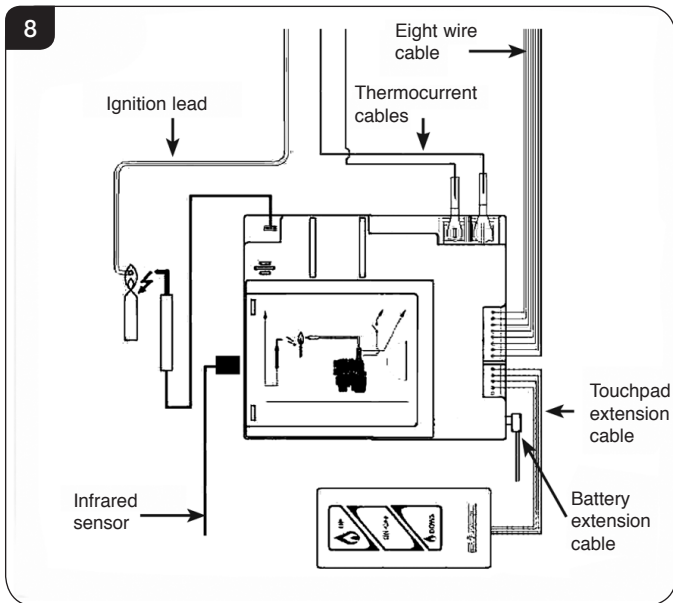

- 7.5 Remove the battery extension cable, see Diagram 8.
7.6 Remove touchpad extension cable and Infrared Sensor.
The control box can now be replaced.

After replacing the control box you may need to reprogram the handset.

To do this press and hold the reset button on the control box until you hear two signals. After the second longer signal:

- Release the reset button and within 20 seconds.
- Press the DOWN button on the handset until you hear an additional long signal confirming the new code.

- 7.7 Refer to separate handset instructions to set new code.

8. Infrared Sensor

- 8.1 The infrared sensor is located on the right hand side of the appliance, under the decorative panel, see Diagram 9.

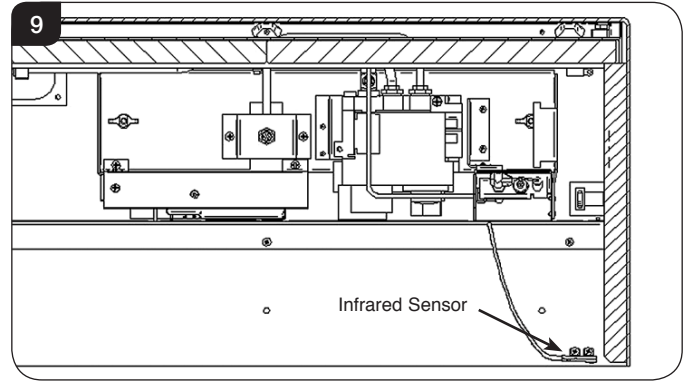

- 8.2 Remove the decorative panel from the appliance.
8.3 Undo the 2 pozi head screws holding the infrared sensor and remove the infrared sensor cable from the right hand side of the control box.
The cable and plug pull out of the control box. If necessary remove the control box assembly to aid access, see Section 7.
8.4 Refit the replacement sensor and the decorative pad.
Make sure the infrared eye lines up correctly with the cut out in the decorative panel.
8.5 Check operation of the system.

9. Gas Valve

- 9.1 To change the gas valve disconnect:
- the inlet pipe
 - the feed pipe
 - the pilot pipe
 - the thermocouple, thermocurrent wires and interrupter block
- See Diagram 10.
- 9.2 Remove the 2 screws that secure the valve to the control bracket.
The cable can now be removed from the valve.

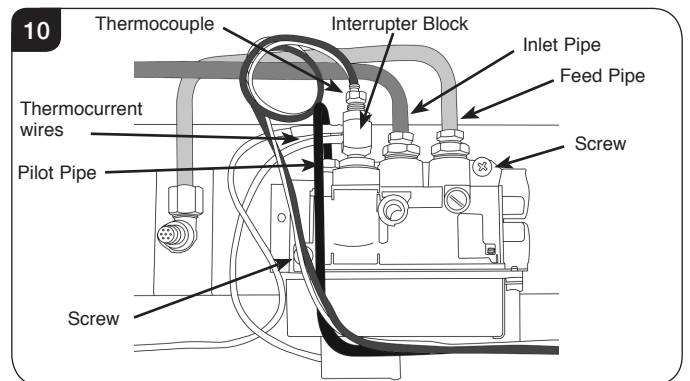

Servicing Instructions - Replacing Parts

10. Changing between Gas Types

A kit of parts is available for this - Contact your Gazco retailer for further information.

Always quote the Model number and Serial number when ordering any spare parts.

11. Black Granite Options

The dimensions of the optional black granite panels are as follows:

Model		Studio 1	Studio 2	Studio 3
Side Panel	Height	316	316	316
	Width	271	271	271
	Thickness	20	20	20
Rear Panel	Height	316	316	316
	Width	634	417	612
	Thickness	20	20	20

Servicing Instructions - Replacing Parts

12. Short Spares List - Studio 1

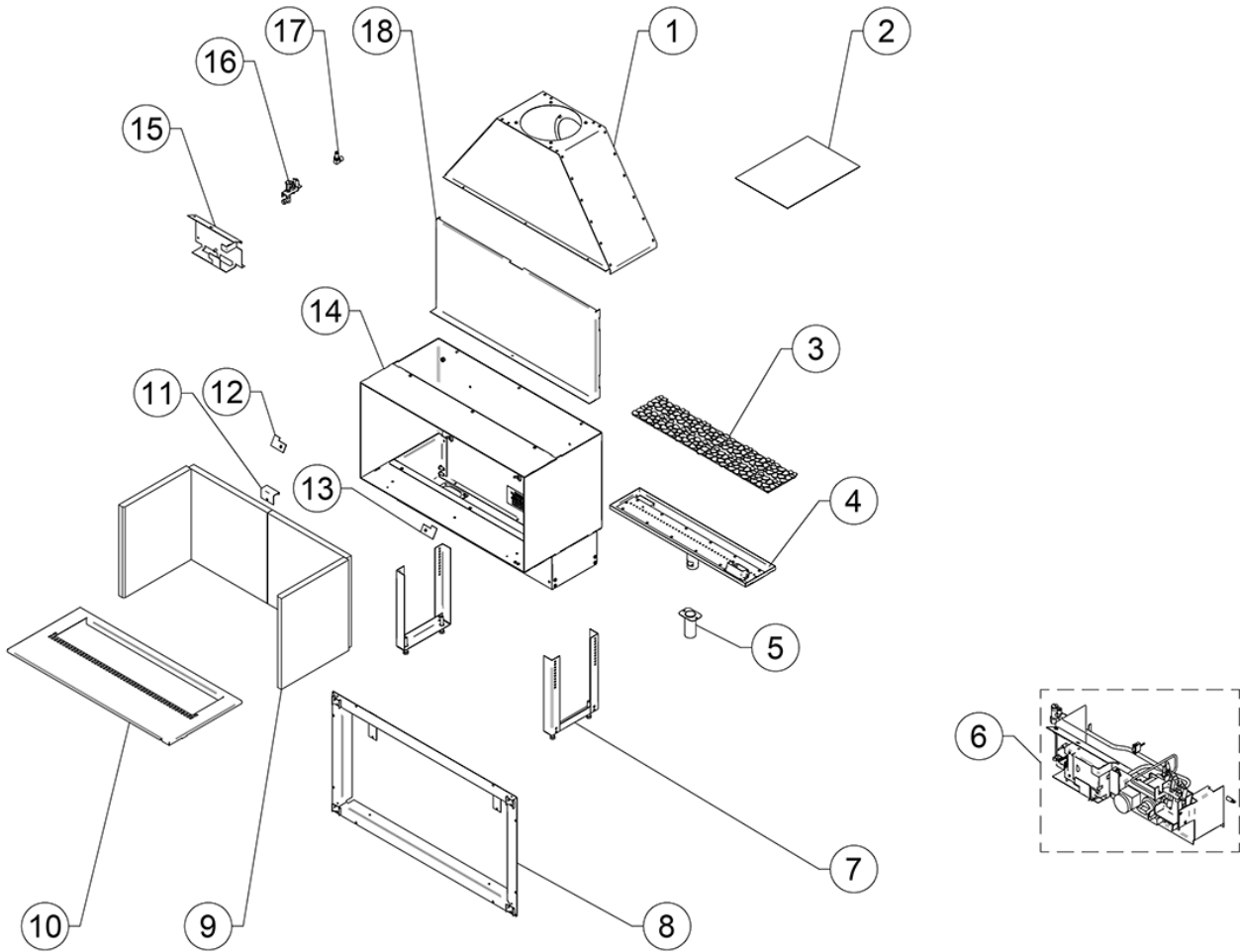

No.	Component	Part Code		Quantity
		Natural Gas	LPG	
1	Gather Assembly	8713		1
2	Instructions Fixing Kit	GZ7425		Kit
3	White Marble Pebbles	CE1274		3
4	Burner Assembly	GZ5949	GZ5948	1
5	Venturi Tube	GZ5704	GZ5217	1
6	Engine Assembly	GZ6627N	GZ6627P	1
7	Levelling Foot Assembly	GZ5415		Kit
8	Sub Frame Support Assembly	GZ5254		1
9	Granite Lining	8714GBK		Kit
10	Inner Cover	GZ7339		1
11	Granite Retaining Bracket	GZ5710		1
12	Top Baffle Infill L/H	GZ5121		1
13	Top Baffle Infill R/H	GZ5140		1
14	Main Housing Assembly	GZ7334		1
15	Receiver Support Bracket	GZ6632		1
16	Pilot	PI0044	PI0045	1
17	Elbow injector	Size 390 IN0028	Size 185 IN0040	1
18	False Back Panel	GZ5118		1



Due to continual technical improvements please check online or with your Gazco retailer for the most up to date parts lists.

Only use Genuine Gazco spares when servicing your appliance. All of our essential spare parts and consumable items are available to purchase from our webshop at: www.gazcospares.com.

Servicing Instructions - Replacing Parts

12. Short Spares List - Studio 2

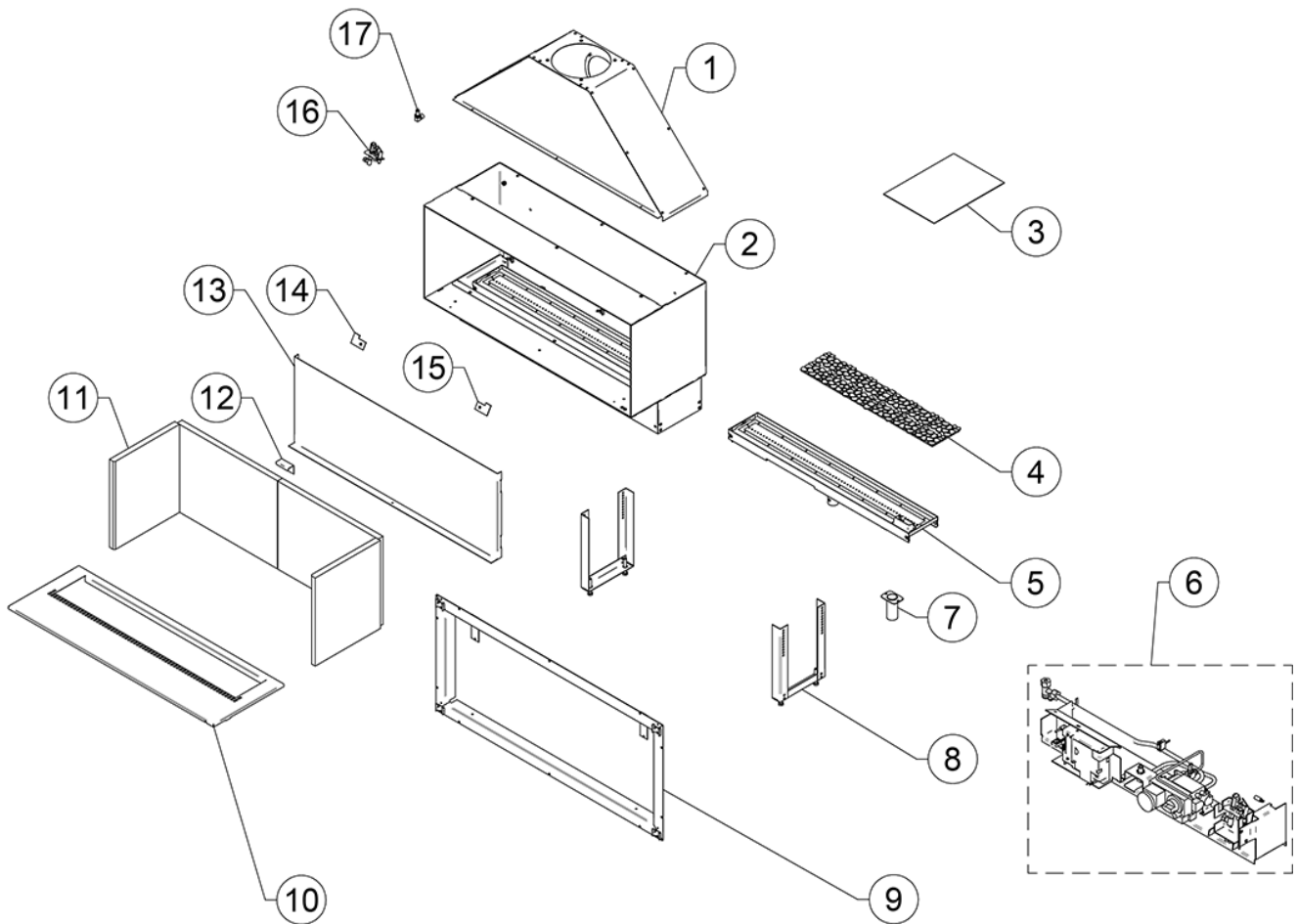

No.	Component	Part Code		Quantity
		Natural Gas	LPG	
1	Gather Assembly	GZ5189		1
2	Main Housing Assembly	GZ6650		1
3	Instructions Fixing Kit	GZ7425		Kit
4	White Marble Pebbles	CE1274		4
5	Burner Assembly	GZ6654	GZ6748	1
6	Engine Assembly	GZ6664N	GZ6664P	1
7	Venturi Tube	GZ5704	GZ5217	1
8	Levelling Foot Assembly	GZ5110		Kit
9	Sub Frame Support Assembly	GZ5725		1
10	Inner Cover	GZ7340		1
11	Granite Lining Kit	8715GBK		Kit
12	Granite Retaining Bracket	GZ5710		1
13	Back Panel Lining Support	GZ5199		1
14	Top Baffle Liner Infill L/H	GZ5121		1
15	Top Baffle Liner Infill R/H	GZ5140		1
16	Pilot	PI0044	PI0045	1
17	Elbow injector	Size 560 IN0046	Size 158 IN0060	1



Due to continual technical improvements please check online or with your Gazco retailer for the most up to date parts lists.

Only use Genuine Gazco spares when servicing your appliance. All of our essential spare parts and consumable items are available to purchase from our webshop at: www.gazcospares.com.

Servicing Instructions - Replacing Parts

12. Short Spares List - Studio 3

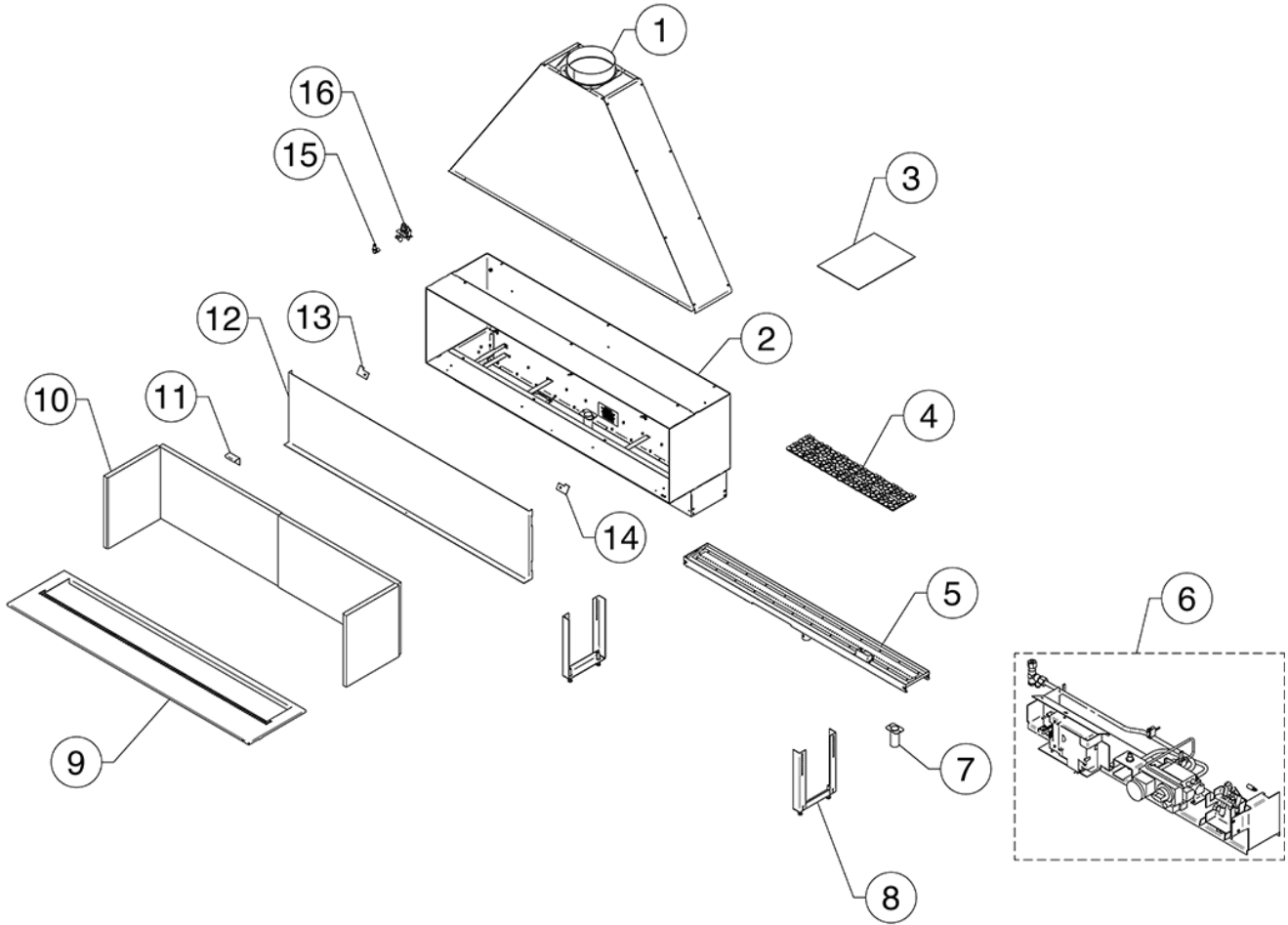

No.	Component	Part Code		Quantity
		Natural Gas	LPG	
1	Gather Assembly	GZ5688		1
2	Main Housing Assembly	GZ6675		1
3	Instructions Fixing Kit	GZ7425		Kit
4	White Marble Pebbles	CE1274		5
5	Burner Assembly	GZ6678	GZ6750	1
6	Engine Assembly	GZ7490N	GZ7490P	1
7	Venturi Tube	GZ5704	GZ5217	1
8	Levelling Foot Assembly	GZ5110		Kit
9	Inner Cover	GZ7342		1
10	Granite Lining Set	8716GBK		Kit
11	Granite Retaining Bracket	GZ5710		1
12	Back Panel Lining Support	GZ5694		1
13	Top Baffle Liner Infill L/H	GZ5121		1
14	Top Baffle Liner Infill R/H	GZ5140		1
15	Elbow injector	Size 110 IN0063	Size 184 IN0061	1
16	Pilot	PI0044	PI0045	1

i Due to continual technical improvements please check online or with your Gazco retailer for the most up to date parts lists.

Only use Genuine Gazco spares when servicing your appliance.

All of our essential spare parts and consumable items are available to purchase from our webshop at www.gazcospares.com.

Servicing Instructions - Replacing Parts

12. Short Spares List - Control Assembly (All Models)

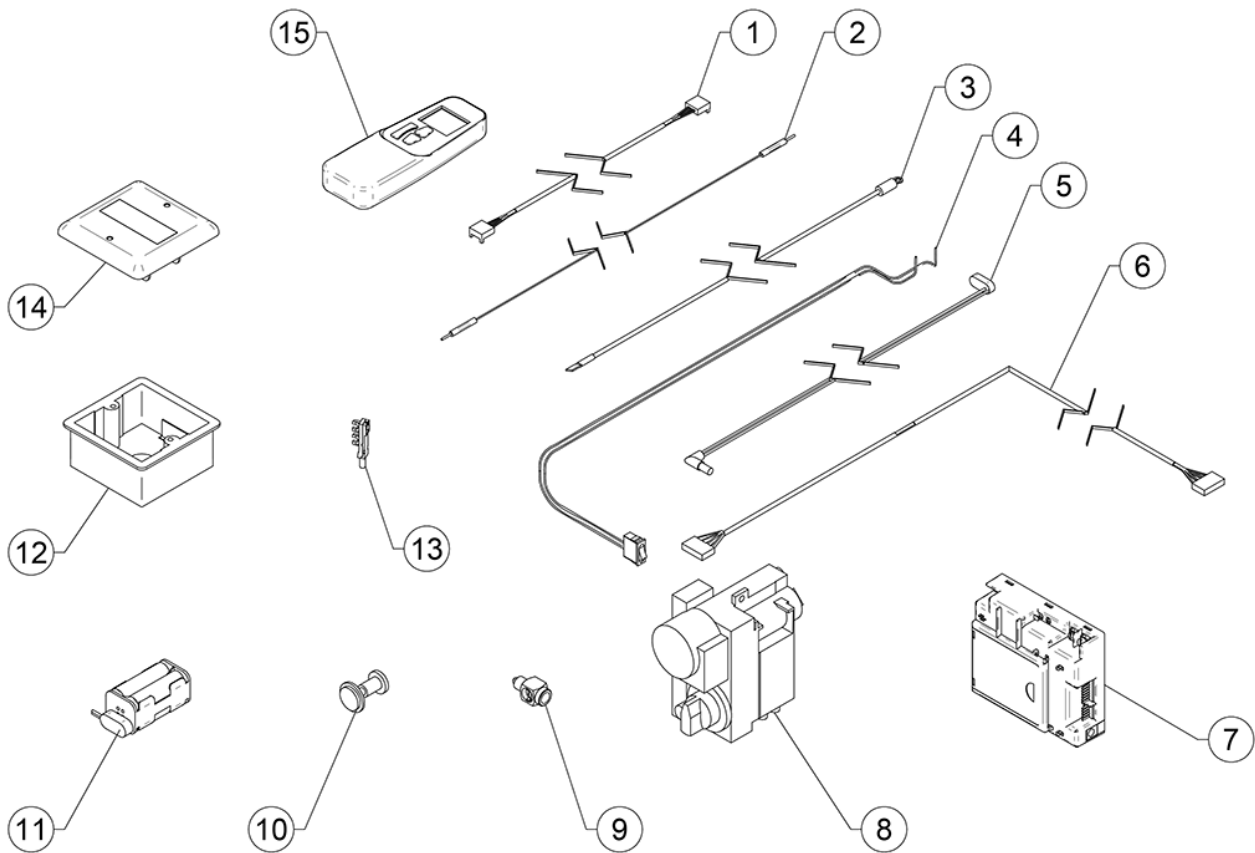

No.	Component	Part Code	Quantity
1	3m Cable Wall Switch Lead	GC0144	1
2	Ignition Cable	GC0125	1
3	Thermocurrent Cable	GC0126	1
4	Touchpad Cable	GC0145	1
5	3m Battery Cable	GC0138	1
6	350mm Connection Cable	GC0133	1
7	Receiver	GC0141	1
8	Gas Valve	GC0123K	1
9	Interrupter Block	GC0124	1
10	Magnetic Unit	GC0166	1
11	Battery Holder	EL0410	1
12	Wall Box	EL0409	1
13	IR Sensor	GC0142	1
14	Touchpad/ Wall Plate Assembly	GC0164	1
15	Handset	GC0148	1



Due to continual technical improvements please check online or with your Gazco retailer for the most up to date parts lists.

Only use Genuine Gazco spares when servicing your appliance.

All of our essential spare parts and consumable items are available to purchase from our webshop at www.gazcospares.com.

Service Records

1ST SERVICE

Date of Service
Next Service Due
Signed
Retailer's Stamp/GasSafe Registration Number

3RD SERVICE

Date of Service
Next Service Due
Signed
Retailer's Stamp/GasSafe Registration Number

5TH SERVICE

Date of Service
Next Service Due
Signed
Retailer's Stamp/GasSafe Registration Number

7TH SERVICE

Date of Service
Next Service Due
Signed
Retailer's Stamp/GasSafe Registration Number

9TH SERVICE

Date of Service
Next Service Due
Signed
Retailer's Stamp/GasSafe Registration Number

2ND SERVICE

Date of Service
Next Service Due
Signed
Retailer's Stamp/GasSafe Registration Number

4TH SERVICE

Date of Service
Next Service Due
Signed
Retailer's Stamp/GasSafe Registration Number

6TH SERVICE

Date of Service
Next Service Due
Signed
Retailer's Stamp/GasSafe Registration Number

8TH SERVICE

Date of Service
Next Due
Signed
Retailer's Stamp/GasSafe Registration Number

10TH SERVICE

Date of Service
Next Service Due
Signed
Retailer's Stamp/GasSafe Registration Number

Gazco Limited, Osprey Road, Sowton Industrial Estate, Exeter, Devon, England EX2 7JG
Technical Customer Services: (01392) 261950 Fax: (01392) 261951
E-mail: technicalservices@gazco.com

A member of the Stovax Group
E & O E